

Goodwin House Alexandria

Walsh Colucci Lubeley & Walsh PC, attorney
Perkins Eastman, architect
Bowman Consulting, civil engineer
Michael Vergason, landscape architect

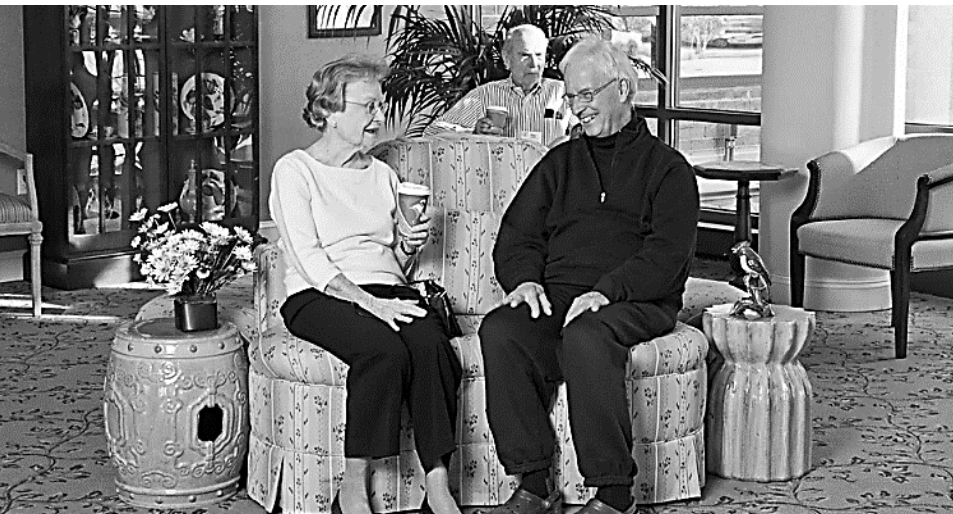

Initial Presentation to
Beauregard Design Advisory Committee
July 28, 2014



Location Map

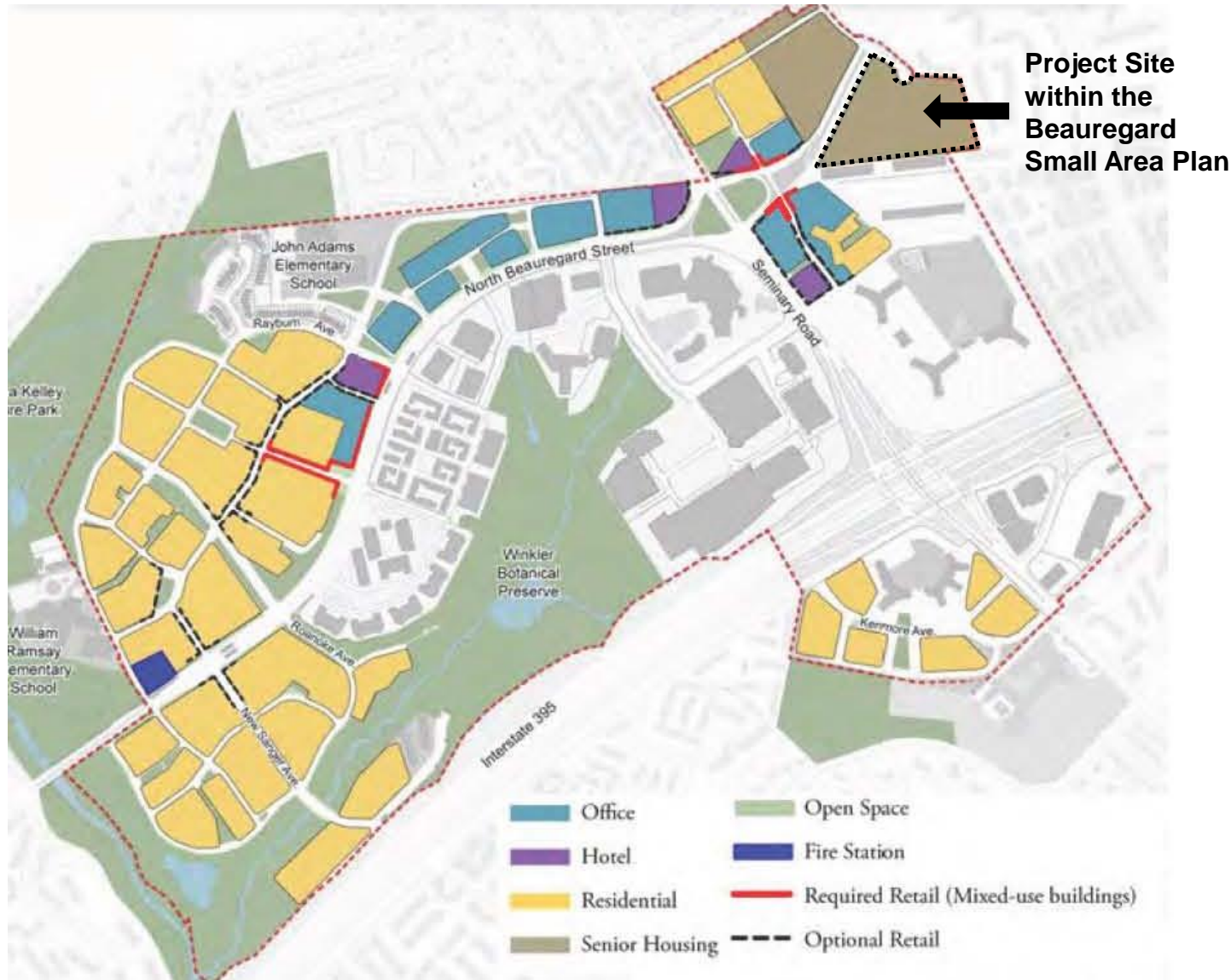

Aerial Photograph



GOODWIN HOUSE
ALEXANDRIA

Perkins Eastman

Existing Site Plan

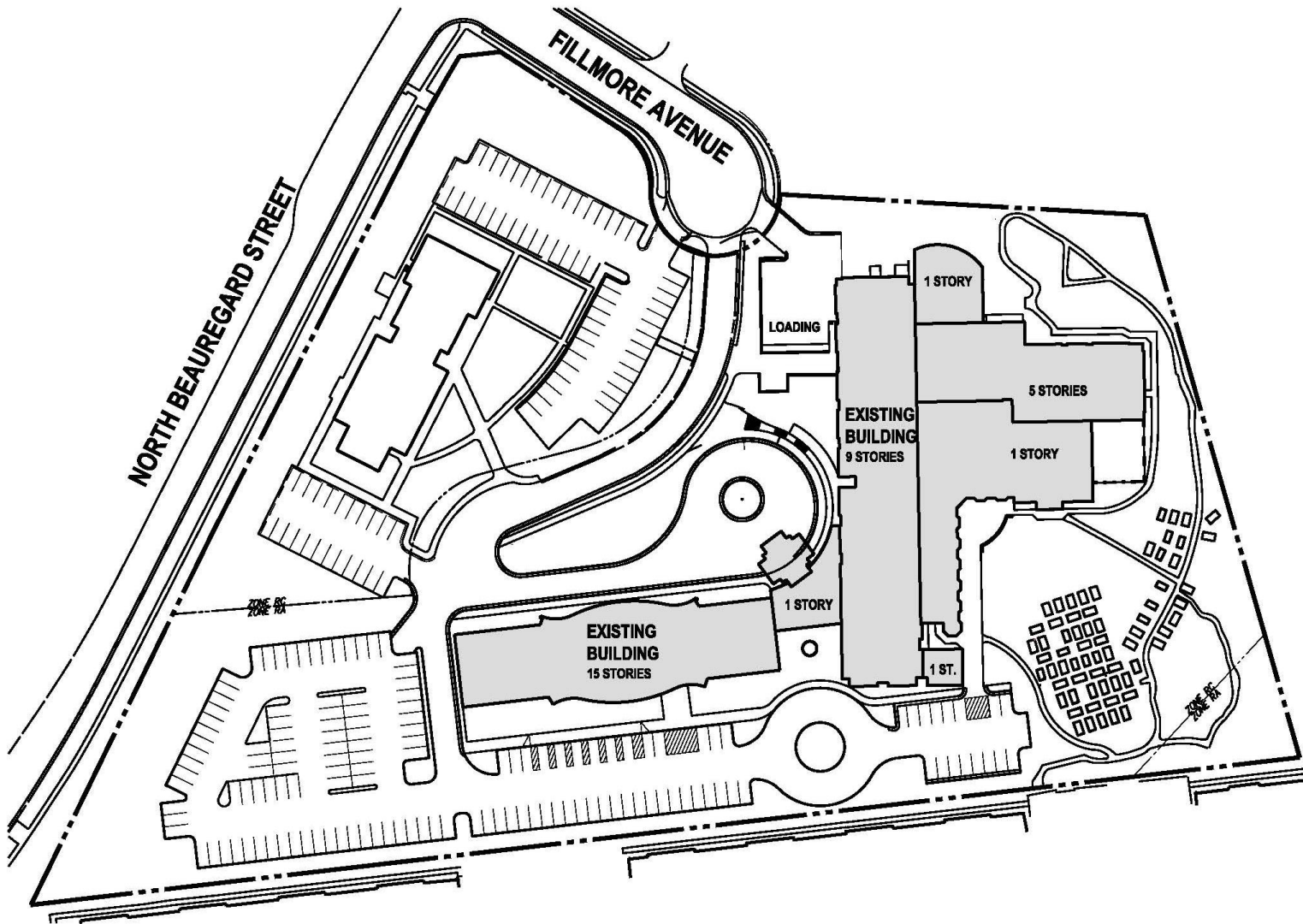

GOODWIN HOUSE
ALEXANDRIA

Perkins Eastman

Goodwin House Alexandria 2040 Plan

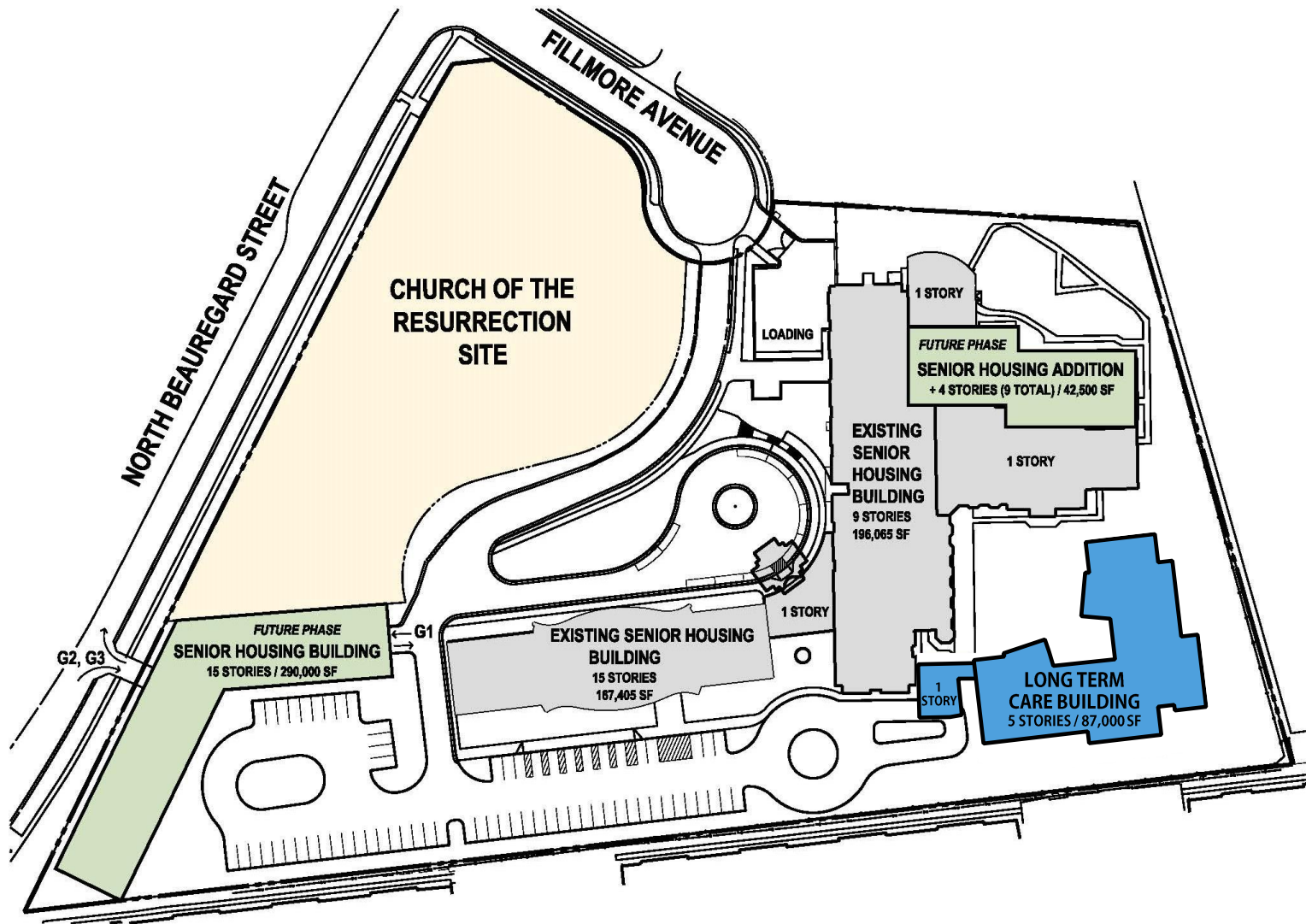

GOODWIN HOUSE
ALEXANDRIA

Perkins Eastman

Landscape Plan



GOODWIN HOUSE
ALEXANDRIA

Perkins Eastman

Typical Floor Plan

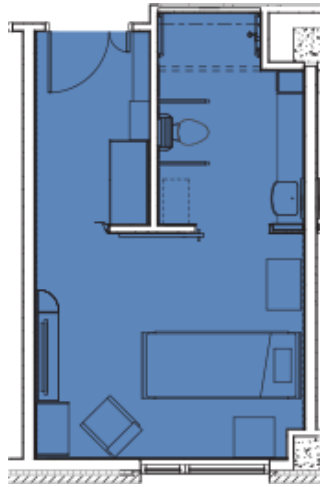

RESIDENT ROOM



GOODWIN HOUSE
ALEXANDRIA

Perkins Eastman

Axonometric Views

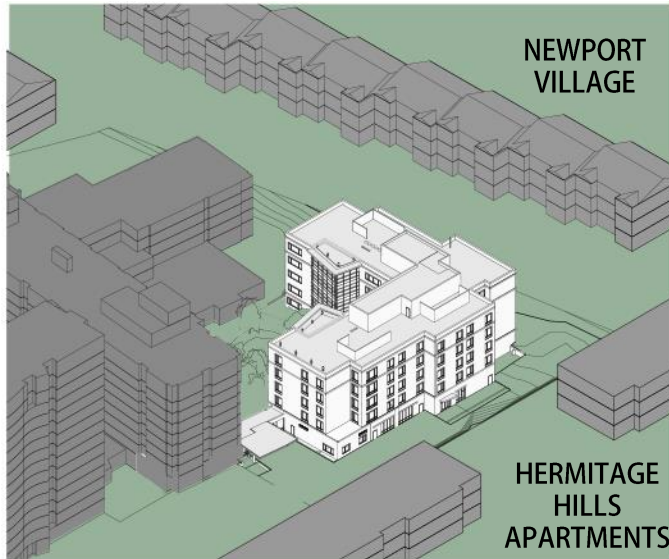

① SOUTHWEST VIEW

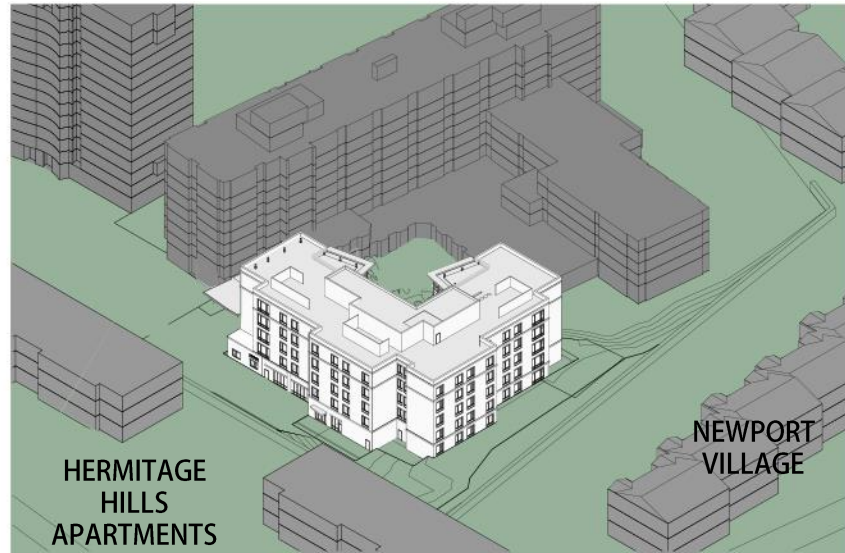

② SOUTHEAST VIEW

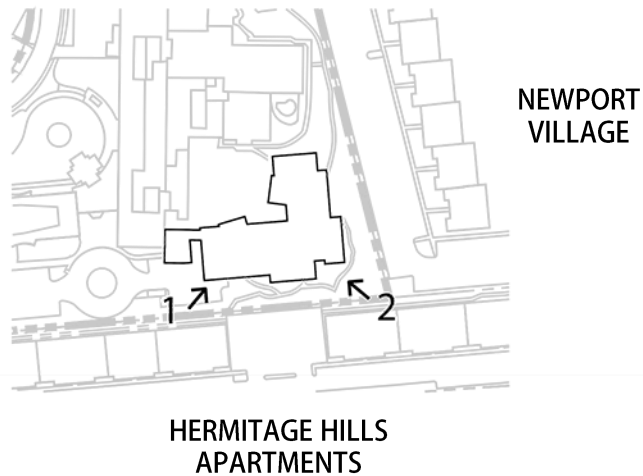

GOODWIN HOUSE
ALEXANDRIA

Perkins Eastman

Axonometric Views

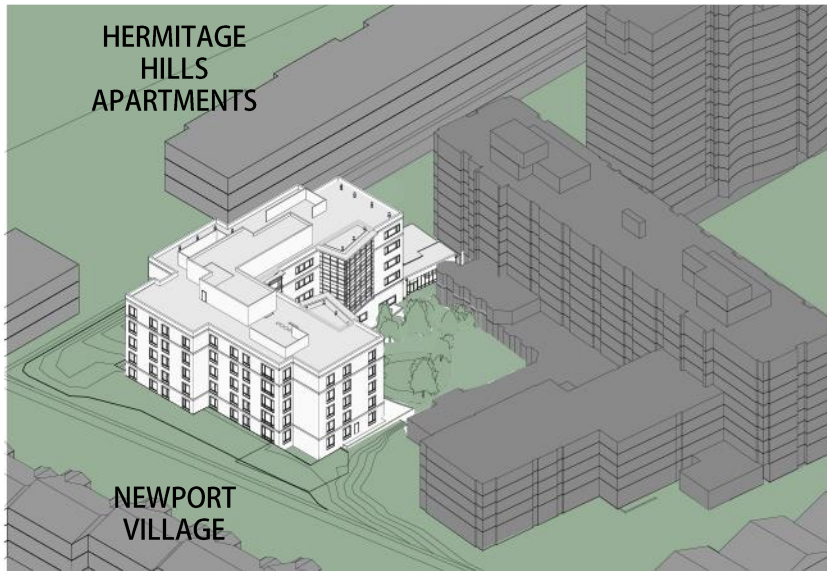

③ NORTHEAST VIEW

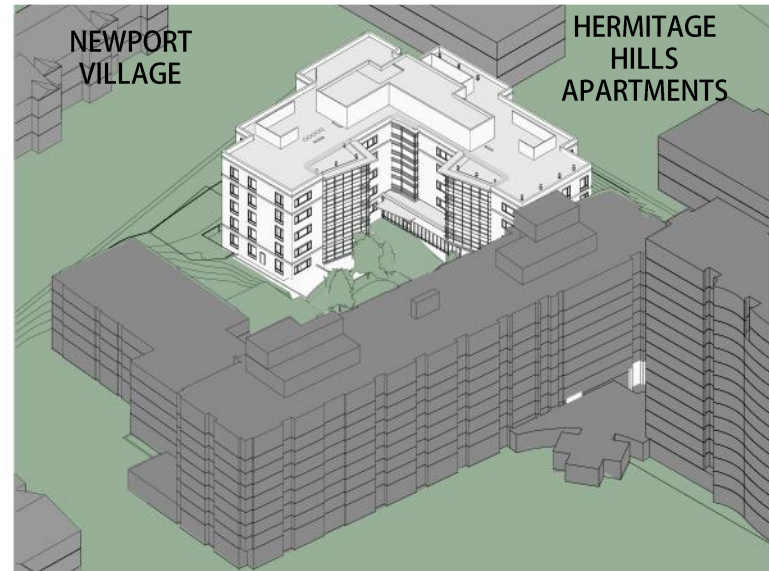

④ NORTHWEST VIEW

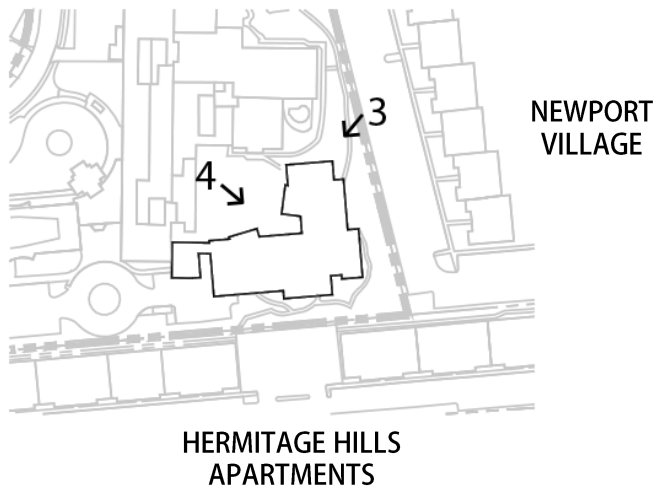

GOODWIN HOUSE
ALEXANDRIA

Perkins Eastman

Site Sections

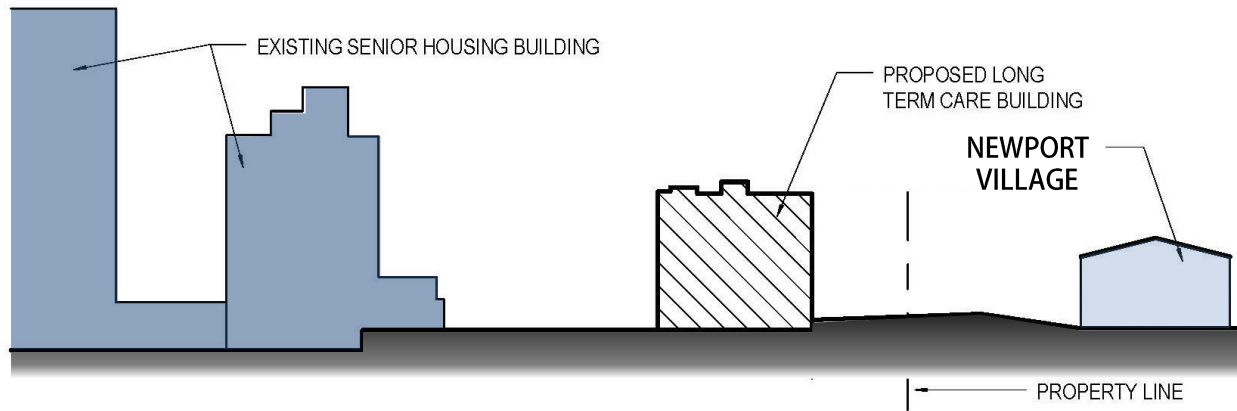

① EAST-WEST SITE SECTION

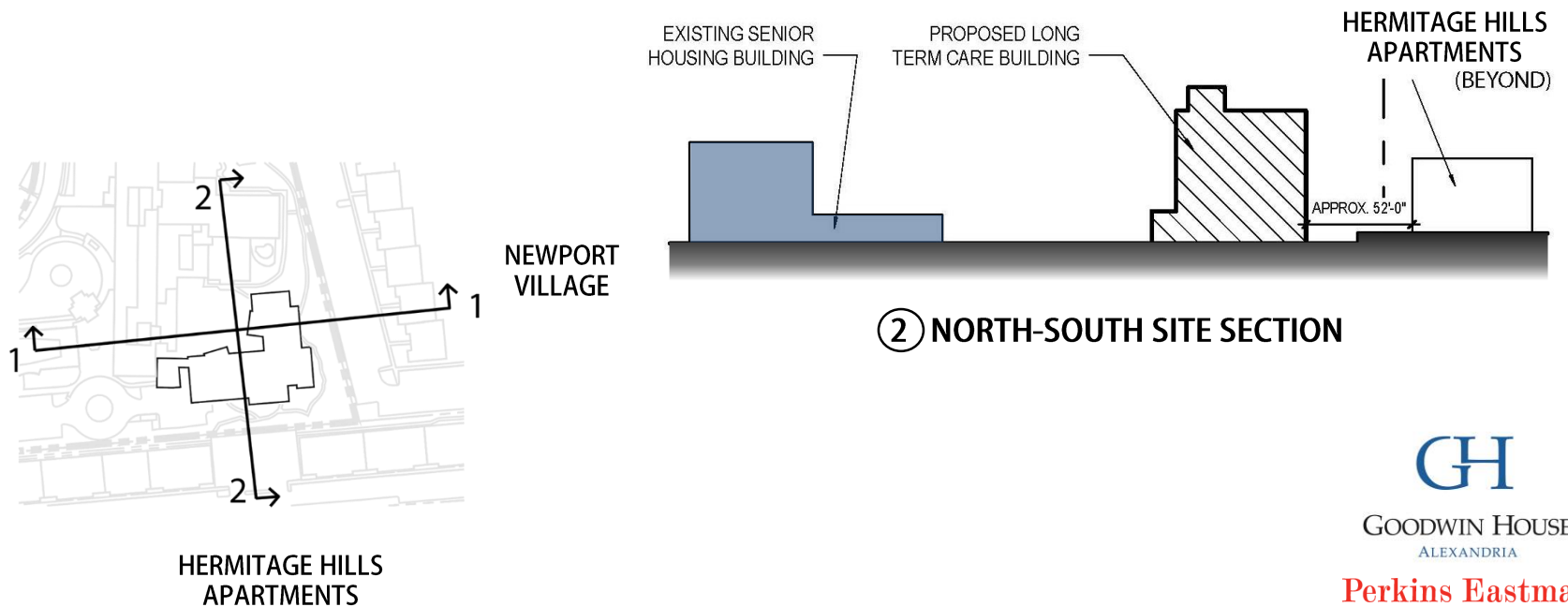

GOODWIN HOUSE
ALEXANDRIA

Perkins Eastman

Existing Campus



Existing Materials

Multiple Brick Tones

Exterior Finish System

Precast Accents

Decorative Panels

Painted Mullions

GH

GOODWIN HOUSE
ALEXANDRIA

Perkins Eastman

Existing Campus



Architectural Queues

Top Floor
Expressed
Differently

Paired Resident
Room Windows
with Decorative
Panels

Large Areas of
Glazing

Courtyard
Structures

GH

GOODWIN HOUSE
ALEXANDRIA

Perkins Eastman

Perspective View



GH

GOODWIN HOUSE
ALEXANDRIA

Perkins Eastman

Perspective View

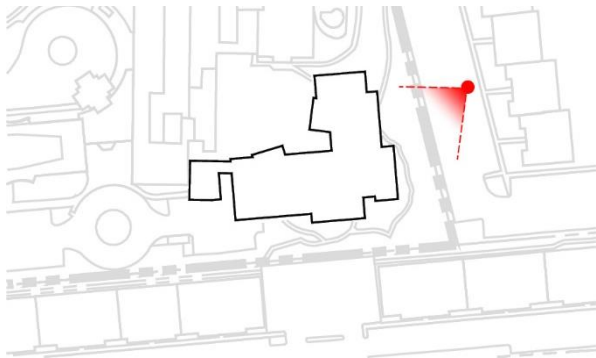

GH

GOODWIN HOUSE
ALEXANDRIA

Perkins Eastman

Perspective View

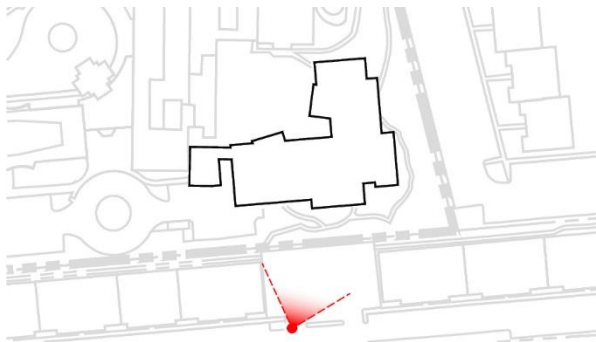

GH

GOODWIN HOUSE
ALEXANDRIA

Perkins Eastman

Perspective View



GH

GOODWIN HOUSE
ALEXANDRIA

Perkins Eastman

Goodwin House Alexandria



GH

GOODWIN HOUSE
ALEXANDRIA

Perkins Eastman