

**ARCHEOLOGICAL EVALUATION OF THE
KING STREET PROPERTIES IN ALEXANDRIA, VIRGINIA:
PHASE I/II ARCHEOLOGICAL INVESTIGATIONS AND
PHASE III DATA RECOVERY OF SITE 44AX0202**



John P. Mullen, M.A., RPA, Boyd Sipe, Christine Jirikowic, Ph.D.,
Johnna Flahive, M.A., and Edward Johnson

November 2007
(First Revision November 2008)
(Final Revision January 2009)
WSSI Project #21397.03

Prepared for:
DSF Long King I, LLC
950 Winter Street
Waltham, Massachusetts 02451

Prepared by:
Thunderbird Archeology
Wetland Studies and Solutions, Inc.
5300 Wellington Branch Drive, Suite 100
Gainesville, Virginia 20155

TABLE OF CONTENTS

ABSTRACT	i
TABLE OF CONTENTS	iii
LIST OF EXHIBITS	v
LIST OF TABLES	vii
LIST OF PLATES	viii
INTRODUCTION	1
ENVIRONMENTAL SETTING	4
HISTORIC CONTEXT AND PROPERTY HISTORY	14
Introduction	14
Early Land Grants	16
Alexandria in the 18th Century	17
Francis Peyton, Early Land Owner	22
Early Development of the Western Portion of Alexandria	22
Continued Development of the Western End of Alexandria	26
New Land Owners in the Mid 19th Century	29
The Civil War Years	35
The Post War Years	45
Early 20th Century	47
Historic Technology of Bored Log Pipes and Log Water Pumps	54
Historic Water and Sewer Services in Alexandria, Virginia and the Region	60
PREVIOUS ARCHEOLOGICAL RESEARCH	64
METHODOLOGY	67
RESULTS OF PHASE I AND II FIELD INVESTIGATIONS	71
Trench 2	78
Trench 3	84
Trench 4	99
Trench 6	104
Trench 7	118
Trench 8	137
Trench 9	143
Trench 10	152
Summary and Recommendations	178
RESULTS OF PHASE III DATA RECOVERY AT SITE 44AX0202	189
Excavation Block 1	189
<i>Feature 5</i>	189
Excavation Block 2	201
<i>Feature 13</i>	207
<i>Feature 14</i>	213
<i>Feature 14a</i>	214
<i>Feature 15</i>	221

Material Culture	244
<i>Ceramic Types</i>	<i>249</i>
<i>Bottle Glass</i>	<i>265</i>
<i>Architectural Artifacts</i>	<i>265</i>
<i>Other Artifacts</i>	<i>273</i>
<i>Artifacts and Period of Occupation</i>	<i>273</i>
Site Occupants and Owners	274
Discussion of Site Features	283
<i>Cobble Stone Feature</i>	<i>283</i>
<i>Wooden Box Culverts/Conduits</i>	<i>284</i>
<i>Barrel Cistern and Bored Log Pipe (Feature 15).....</i>	<i>287</i>
<i>Brick Well.....</i>	<i>288</i>
<i>Late 19th/Early 20th Century Features</i>	<i>288</i>
SUMMARY AND CONCLUSIONS	295
REFERENCES CITED	297
APPENDIX I	305
Results of Monitoring	305
RESULTS OF MONITORING	307
Well Feature	307
<i>Methodology</i>	<i>309</i>
<i>Fill Deposits within Well Feature.....</i>	<i>309</i>
<i>Log Pump Construction</i>	<i>317</i>
Summary and Conclusions.....	319
Plates	321
APPENDIX II.....	345
Scope of Work	345
APPENDIX III	357
Artifact Inventory	357
APPENDIX IV	413
Cultural Resource Forms	413

APPENDIX I
Results of Monitoring

RESULTS OF MONITORING

Archeological monitoring of excavation within the project area was required by the City of Alexandria under special use permit conditions for the development. The purpose of this monitoring was to locate and document any additional cultural features that may be considered significant. Monitoring was conducted in August 2007.

The entire project area, to the south of the existing buildings fronting King Street, was excavated in order to construct an underground parking garage (Exhibit 65). The project area was first divided into quadrants. Using a trackhoe with a five-foot bucket, the soils within each quadrant were to be evenly excavated in five foot increments. After the removal of five feet of soil across the entire project area, the next five feet of soil would be removed, and so forth.

The northeast quadrant was excavated first, approximately five feet below ground surface (Plate 105); next, the southeast quadrant was excavated slightly deeper to approximately seven feet below ground surface (Plate 106). A strip of land approximately 20 feet wide was left unexcavated between the northeast and southeast quadrants. The crew then worked westward along the southern property boundary taking the southwest quadrant down to approximately seven to eight feet below ground surface (Plate 107) and the strip of land between the northeast and southeast quadrants was removed. Finally, the first five feet of soil were removed from the northwest quadrant (Plate 108). Once the entire site had been excavated five to eight feet (Plate 109), the entire project area was then leveled by quadrants to approximately ten feet below ground surface. A small earthen ramp in the southwest corner of the property was left unexcavated for access into the property.

One feature, associated with site 44AX0202, was found near the base of the first excavation level, within the northeastern quadrant of the property and is discussed below.

Well Feature

During excavation of the first five feet of the northeastern portion of the property, a brick lined well was discovered at an elevation of approximately 13 feet above sea level (see Exhibit 65; Plate 110). The circular brick feature appears to have been located beneath the footprint of the previously demolished building and was filled with building debris. The well measured six feet in diameter and a wooden log pipe, possibly part of a pump mechanism, was located in the center (Plate 111). At the time of discovery, the area surrounding the well was cleared and graded to the level of the exposed portion and the construction crew was instructed not to disturb the area. Decisions regarding the significance of the feature and the level of documentation required were made in consultation with Alexandria Archaeology.

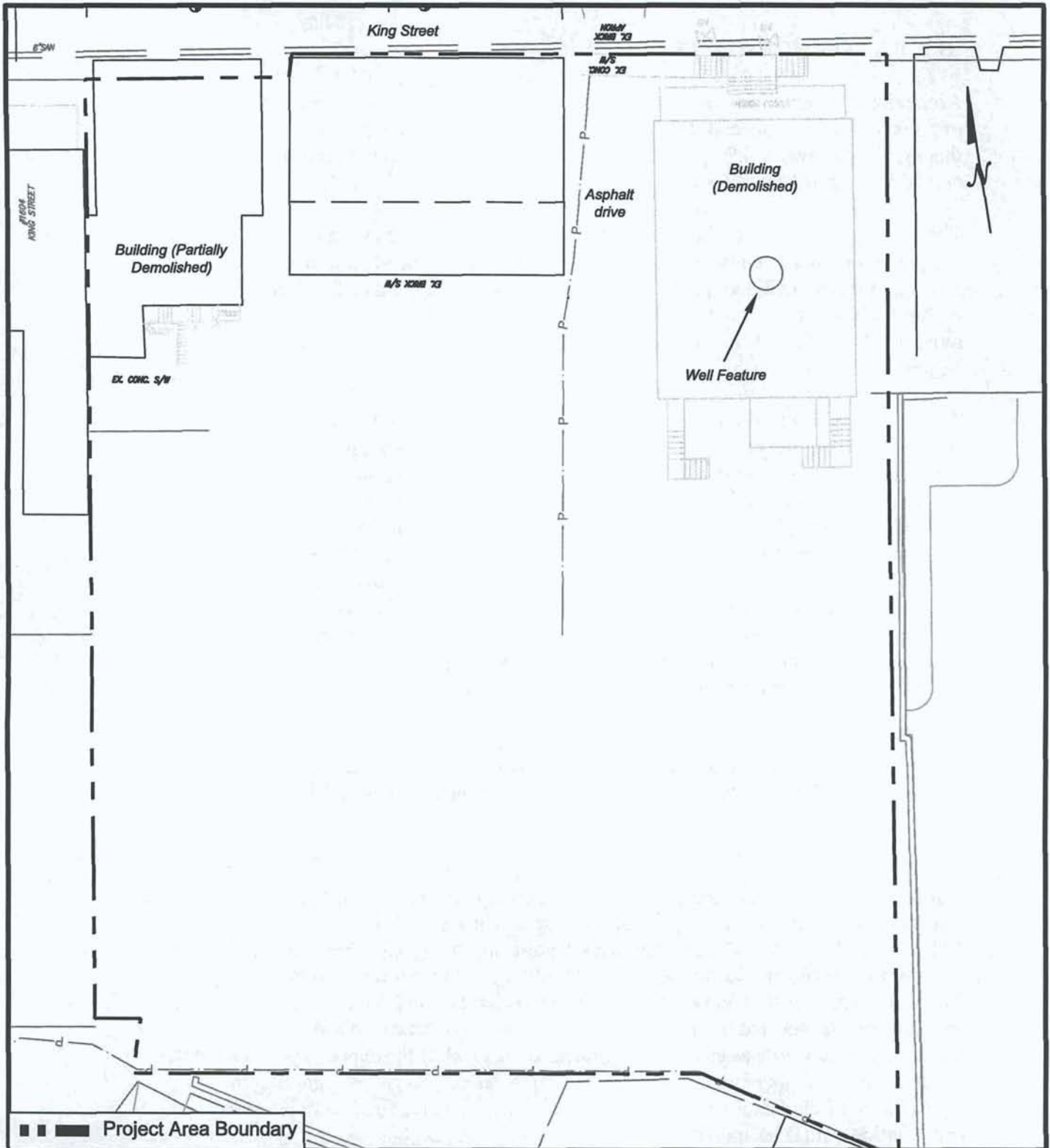

**Project Area Map Showing Archeological Monitoring and Well
King Street Properties WSSI # 21397.03
Scale 1" = 25'**

Methodology

The methodology used to excavate and document the well feature was determined by Alexandria Archaeology. The city archeologists requested that a small bisection of the well first be removed and screened for artifacts to determine the relative age of the fill deposits. Alexandria Archaeology required 100% recovery of any fill deposits that dated to the 19th century (the date of significance for the recorded archeological site on the property).

The well was hand excavated (with trowel and flat shovel) stratigraphically and all soil screened through 1/4-inch mesh hardware cloth screens. Deeper fill deposits were excavated in arbitrary 0.5 foot levels in order to maintain vertical control. Bisection wall profiles and plan views of the feature were photographed and drawn. Soil colors were described using the Munsell Soil Color Chart designations. Additionally, Alexandria Archaeology requested that any portions of the pump mechanism, including the bored wood log pipe, be drawn to scale.

Fill Deposits within Well Feature

The profile of the initial bisection showed eight fill horizons within the well (Plate 112, Exhibit 66).

- Fill 1: 0- 2.1 feet (0- 0.64 m) below surface- mixed 20th century fill horizons
- Fill 2: 2.1- 2.5 feet (0.64-0.76 m) below surface- [10YR 3/2] very dark graying brown sand
- Fill 3: 2.5- 3.0 feet (0.76- 0.91 m) below surface- [10YR 5/4] yellowish brown sand with quartz pebbles
- Fill 4: 3.0- 4.3 feet (0.91- 1.3 m) below surface- [10YR 3/2] very dark grayish brown sandy clay
- Fill 5: 4.3- 4.7 feet (1.3- 1.4 m) below surface- [2.5Y 6/4] light yellowish brown sandy clay
- Fill 6: 4.7- 5.0 feet (1.4- 1.5 m) below surface- [2.5Y 5/3] light olive brown wet sand with some clay
- Fill 7: 5.0- 5.8 feet (1.5- 1.8 m) below surface- [2.5Y 3/1] very dark gray wet sand
- Fill 8: 5.1- 5.6 feet (1.55- 1.7 m) below surface- [2.5Y 5/3] light olive brown wet sand with some clay

The uppermost four fill horizons extended roughly 4-5 feet below the surface of the feature and appeared to slope generally east to west. These levels all contained modern artifacts such as chunks of dry wall, PVC pipes, ceramic electrical insulators, and 20th century jar and bottle fragments). Fills 5 through 8 also generally sloped east to west in profile and extended to a total depth of 5.6 feet below the surface of the feature. Sterile subsoil was not reached at this time. Plates 113 and 114 show the initial excavation of the well. Although the final artifact processing revealed that the lowermost fills contained mixed 19th and 20th century artifacts, it was believed upon field examination that these fill horizons probably dated to the 19th century. Therefore, following

Alexandria Archaeology's scope of work, 100% of the lowermost fills were excavated and screened for artifacts. A complete artifact inventory is included as Appendix III.

The well was bisected in half in order to determine the relation of the bored log pipe to the well. The profile of the second bisection showed five fill horizons overlying a thin layer of decaying wood, a thin layer of clay and natural C horizons (Plate 115; Exhibit 67):

- Fill 1: 0- 2.8 feet (0- 0.85 m) below surface- mixed 20th century fill horizons
- Fill 2: 3.0- 4.9 feet (0.85- 1.5 m) below surface- Alternating layers of [10YR 3/2] very dark grayish brown sand and [10YR 6/1] gray with [10YR 5/6] yellowish brown sandy clay
- Fill 3: 4.9- 5.4 feet (1.5- 1.6 m) below surface- [10YR 4/2] dark grayish brown sand mixed with plaster and brick fragments
- Fill 4: 5.4- 6.2 feet (1.6- 1.89 m) below surface- [10YR 5/2] grayish brown sandy clay with quartz pebbles and brick fragments
- Wood lens: 6.2- 6.25 (1.89- 1.91 m) – [2.5Y 2.5/1] black decaying wood
- Sand lens: 6.25- 6.3 (1.91- 1.92 m) – [10YR 6/1] gray sand
- Clay lens: 6.3- 6.35 (1.92- 1.94 m) – [2.5Y 5/3] light olive brown smooth clay loam
- C horizon: 6.35- 6.7 feet (1.94- 2.0 m) below surface- [10YR 5/2] grayish brown sand

The upper modern fill horizons (Fills 1 and 2) were removed using the trackhoe and discarded without screening (Plate 116). The remaining fill deposits (Fills 3-5) were hand excavated by quadrant (northeast and northwest) using 0.5 foot arbitrary levels and screened for artifacts. Fill 3 was only located on the eastern side of the profile, while Fill 5 was only found on the western side of the wood log pipe. Fill 5, a [10YR 4/1] dark gray sandy clay, was nearly one foot thick and directly overlay the wood lens. On the eastern side of the profile, the Fill 4 horizon overlay the wood lens. A very thin layer of decaying wood was found at the base of the profile overlying a thin sand lens. Beneath this, was a thin layer of clay overlaying sterile C horizons (Plates 117-119). Exhibits 68 and 69 show the lowermost soil horizons in detail.

Finally, the remaining southern half of the well was similarly excavated, although not by quadrant (Plates 120-121).

The builder's trench was clearly visible in profile (see Exhibit 67); in plan view, it encircled the feature unevenly, extending between 0.5- 1.5 feet away from the bricks. The trench was filled with a [2.5Y 6/2] light brownish gray sand and a [2.5Y 6/1] gray clay with [2.5Y 5/4] light olive brown mottling. An oyster shell was observed in the uppermost builder's trench fill; one stoneware sherd, one cut nail and brick fragments were recovered from the bisection at the base of the builder's trench. A plastic fragment was an obvious intrusion into this level and was discarded.

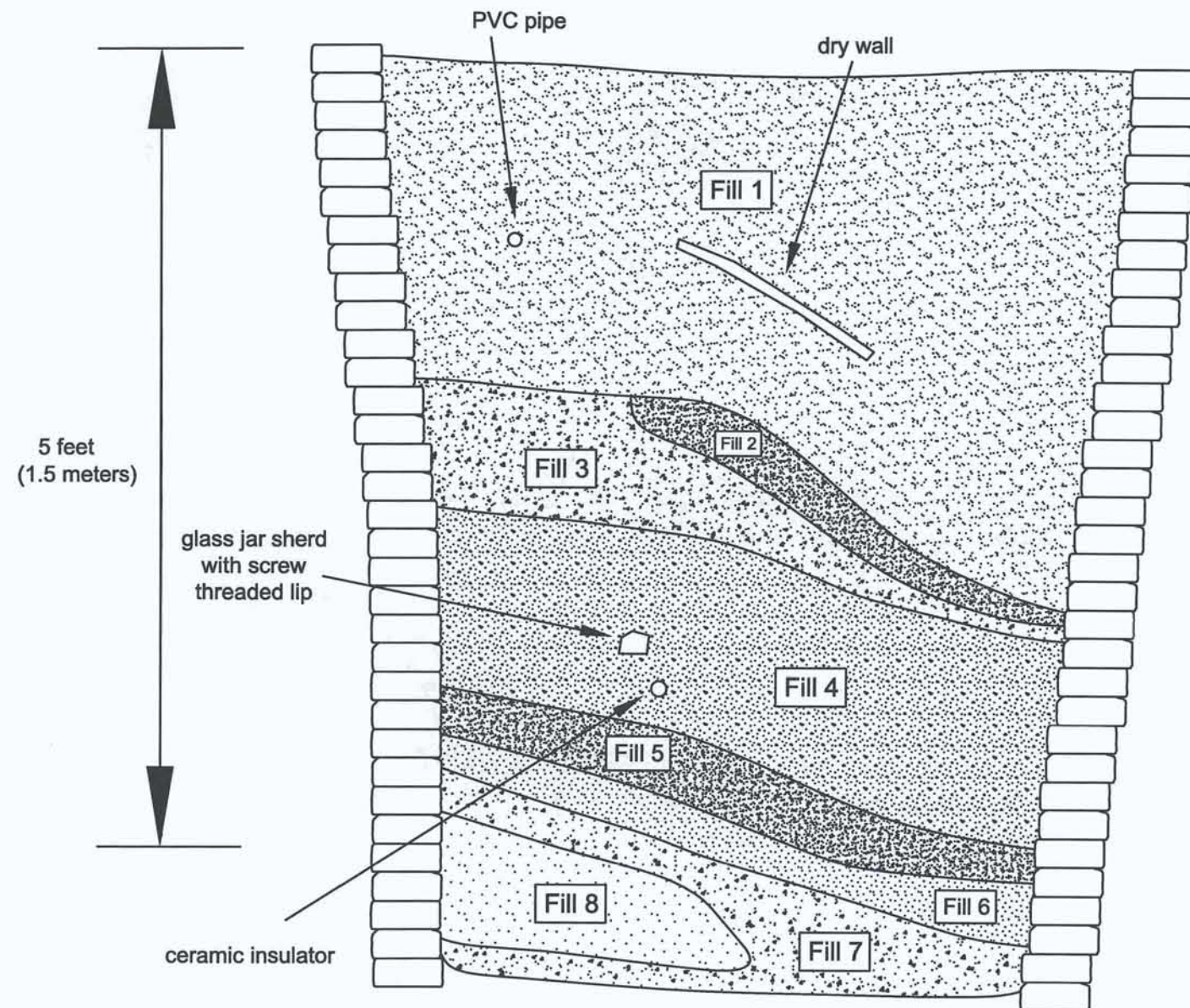

-  Fill 1: Mixed 20th Century Fill Horizons
-  Fill 2: 10YR 3/2 very dark grayish brown sand
-  Fill 3: 10YR 5/4 yellowish brown sand with quartz pebbles
-  Fill 4: 10YR 3/2 very dark grayish brown sandy clay
-  Fill 5: 2.5Y 6/4 light yellowish brown sandy clay
-  Fill 6: 2.5Y 5/3 light olive brown wet sand with some clay
-  Fill 7: 2.5Y 3/1 very dark gray very wet sand
-  Fill 8: 2.5Y 5/3 light olive brown wet sand with some clay

* All fill horizons contain brick fragments and plaster

South Profile of the First Bisection of Well Feature
King Street Properties I-III (44AX0202) - WSSI #21397.03
Scale: 1" = 1'

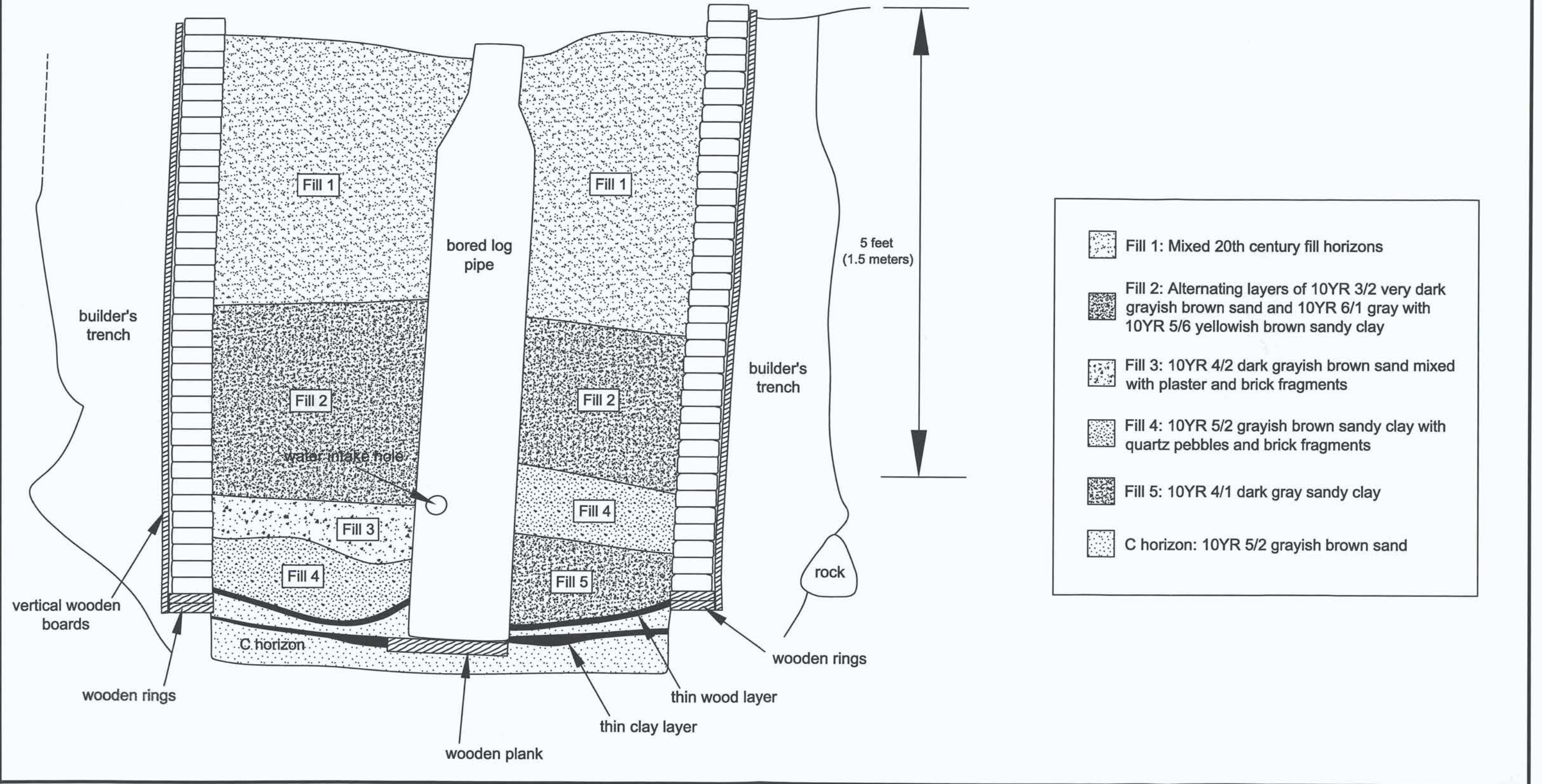

South Profile of the Second Bisection of Well Feature
King Street Properties I-III (44AX0202) - WSSI #21397.03
Scale: 1" = 1'

Plan View at Base of Well

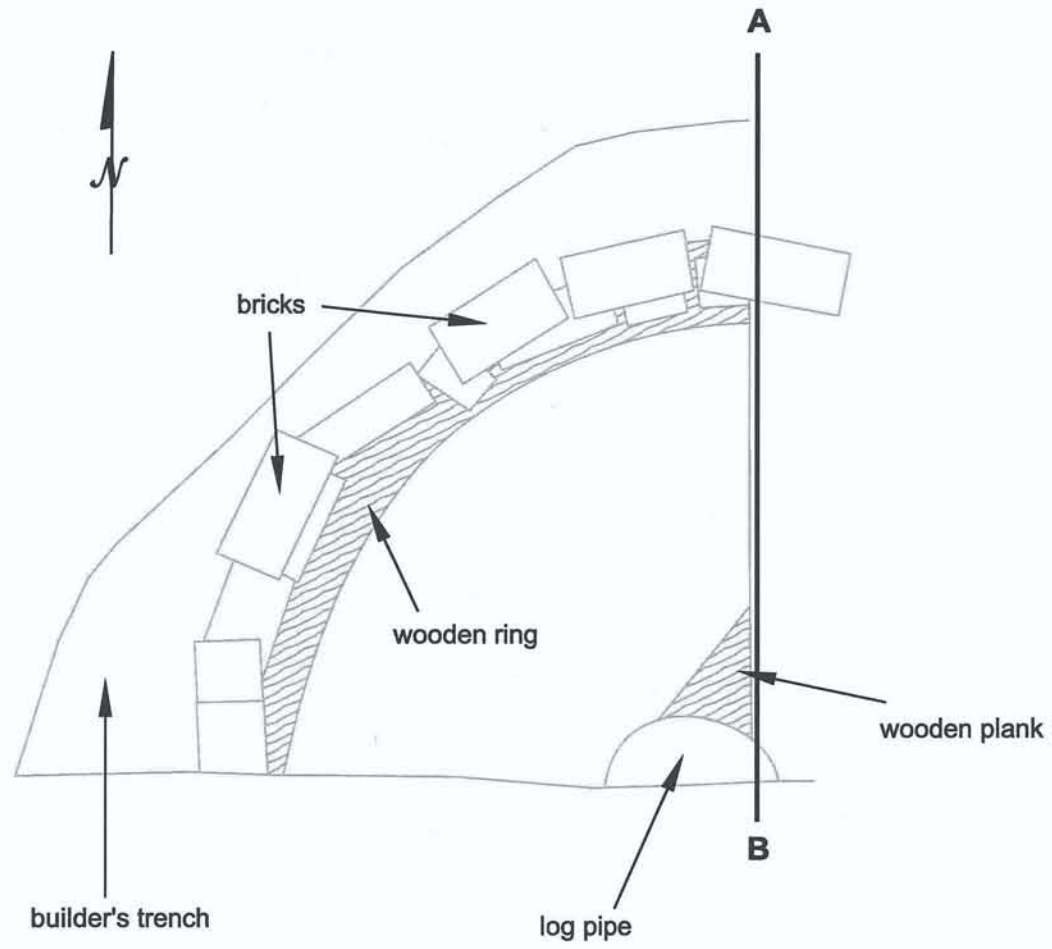

Bisection Profile at Base of Well

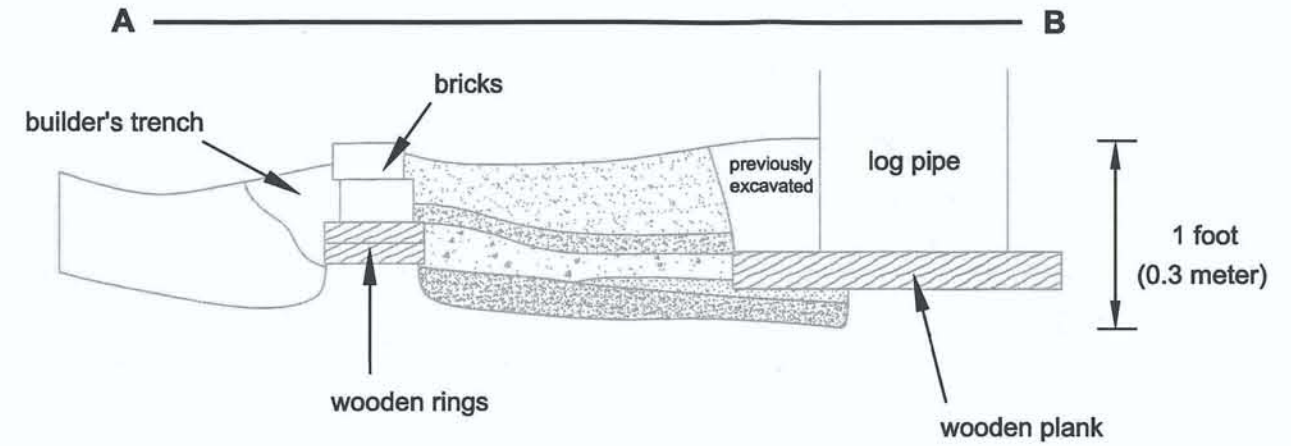

-  Fill 5 - 10YR 4/1 dark gray sandy clay
-  2.5Y 2.5/1 black decaying wood
-  Sand lens - 10YR 6/1 gray sand
-  Clay lens - 2.5Y 5/3 light olive brown smooth clay loam
-  C horizon - 10YR 5/2 grayish brown sand

Plan View and Bisection Profile at Base of Well
King Street Properties I-III (44AX0202) - WSSI #21397.03
Scale: 1" = 1'

Well Construction

The well measured approximately 6 feet in diameter on the outside of the bricks (5 feet on the inside) and was approximately 7 feet deep at the time of excavation. It appears that the upper portion of the well may have been removed during the discovery process; a portion of the wood log pump mechanism was located within the back dirt. The ground surface was most likely higher at the time of construction/use, and the well may have been at least 8 to 9 feet deep at one time.

The well was constructed with stretcher bond dry laid bricks, which were resting within and supported by an exterior wooden frame, which surrounded the bricks. The wood frame consisted of vertical planks measuring approximately 6 to 10 inches wide and 1 inch thick running down the entire exterior of the well, that were nailed to two stacked wooden rings at the base of the well (Plate 122 and see Plate 119). The two stacked wooden rings were constructed of four to five rounded planks each, nailed together to form a circle (see Plate 122 and Exhibit 69). The courses of bricks were laid on top of the wooden ring, flush with the vertical planks.

The builder's trench surrounding the well was irregularly shaped, extending between 0.5-1.5 feet away from the bricks at the top and became narrower towards the bottom of the well. The trench was filled with a mixture of sand and clay, with the amount of clay content increasing significantly in the lower half of the feature.

The water appears to have been drawn through a bored wooden log pipe that was supported in the center of the well, which rested on a wooden plank (see Plate 115). The log pipe measured approximately 1 foot in diameter and was 6.5 feet in length. The wood plank at the base of the log pipe measure roughly 1.8 by 0.8 feet. A water intake hole had been drilled through the log approximately 1 foot above its base and the bottom of the log was plugged (Plates 123-124).

Log Pump Construction

The log pump which ran through the center of the well was constructed of a large bored log, another smaller bored log which attached to the top of the larger log, and presumably had a pumping mechanism which was not found (Plates 125-126). The large bored log was 6.2 feet long and had been cut to have eight relatively flat even sides, like an octagonal cylinder. The top 1.3 feet of the log had been tapered to fit inside the smaller bored log which likely was attached to the top (see Plates 125-126). The smaller wood log piece was also eight sided and was measured approximately 2.3 feet long. The top of this log had been damaged during the current construction activities, as the well was discovered. The original length of this second log is unknown. Although the pumping mechanism was not recovered, it was most likely a cast iron hand pump which attached to the top of the smaller bored log.

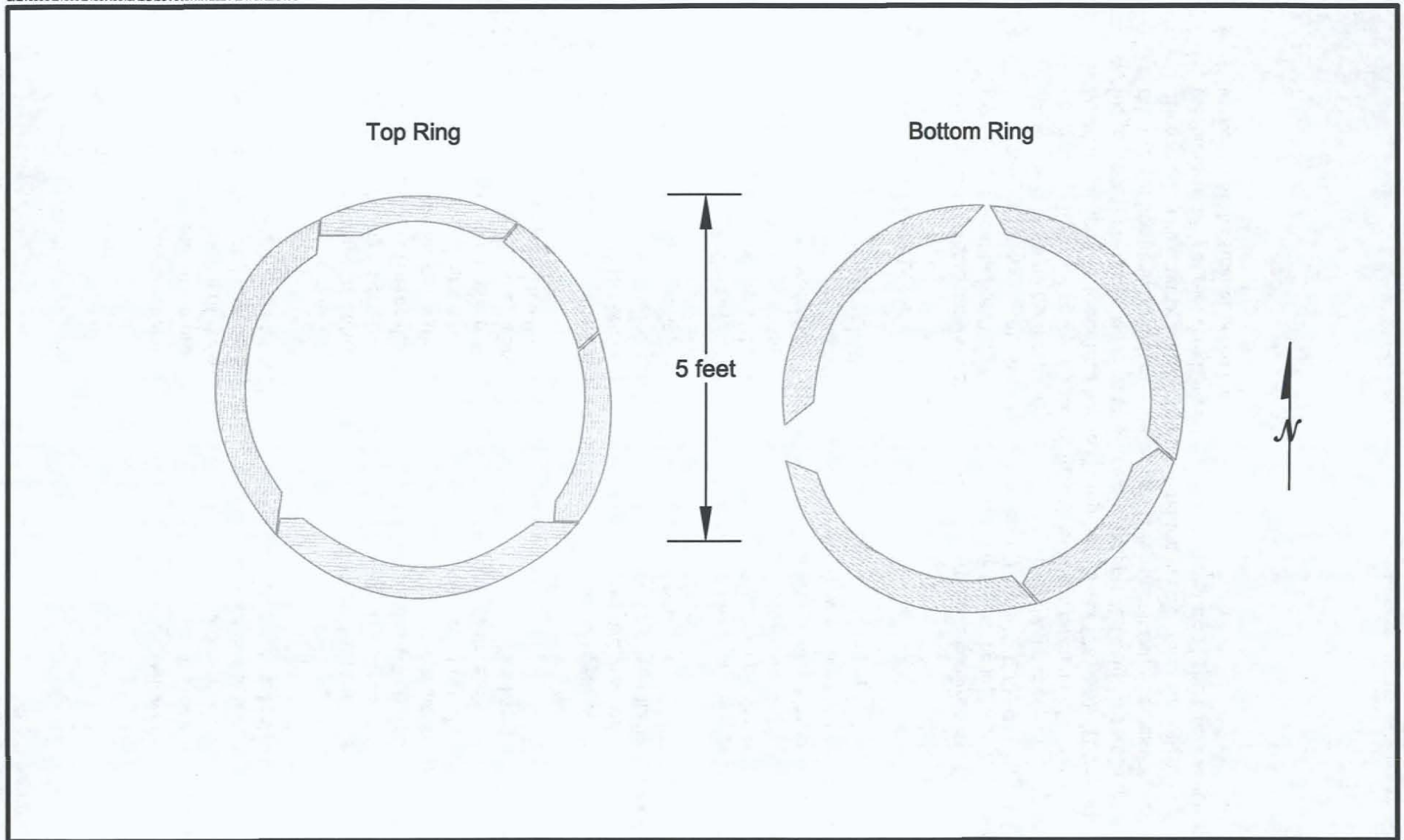

Plan View of Wooden Rings at Base of Well
King Street Properties I-III (44AX0202) - WSSI #21397.03
Scale: 1" = 2'

Summary and Conclusions

According to Alexandria City archeologist Steven Shephard, the well at the King Street property is similar in construction to other wells that have previously been discovered and excavated in Alexandria. A 1989 survey of historic wells in Alexandria found that 19% of the wells were lined with wooden planks and several contained wooden pumps (Shephard 1989). The excavation of this current well feature may offer a structural explanation for the wood planks found lining the wells discovered in Alexandria. It is theorized that the wooden frame was fully constructed above ground, and then lowered into the pit excavated for the well. This wooden frame may have provided protection against collapsing walls within the pit during the laying of brick, and would also serve as a guide for construction. This may have been necessary due to the extremely sandy soils on the property, which would easily collapse if not adequately supported.

Previous archeological work along the 1100 block of King Street resulted in the discovery of similar wood lined well shafts that were thought to date circa 1870-1907, primarily because of their location at the rear of the lot (Smith 1983, cf. Shephard 1989). The well found within the current project area is located at the rear of the house, not the lot, and appears to have been located under an addition, or in the basement of the building (see Exhibit 65). Although the exact construction date of this well is unknown, it likely dates to the 19th century and is included with Site 44AX0202. The well appears to have been abandoned by the late 19th early 20th century, around the time of the construction of the house located at 1514-1524 King Street. The large amount of modern structural debris in the upper four feet of the well appears to have originated from the demolition of the house, suggesting that the well was not entirely filled after abandonment, and may have been covered.

The well (and bored log pump) located during the archeological monitoring is supported by documentary evidence. Land tax records and an *Alexandria Gazette* newspaper advertisement in 1851 indicate that Home constructed a frame dwelling, a brick "negro jail," a cultivated garden, a *water pump*, and several outbuildings on the property. The *water pump* is likely this well.

Archeological monitoring at the King Street properties presented a unique opportunity to fully excavate a historic well from both the interior and exterior and has contributed to the knowledge base of well construction techniques within the city of Alexandria.

Plates



PLATE 105
Excavation of the Northeast Quadrant
View to North



PLATE 106
Excavation of the Southeast Quadrant
View to Northwest



PLATE 107
Excavation of the Southwest Quadrant
View to South



PLATE 108
Excavation of the Northwest Quadrant
View to North



PLATE 109
Overview of Property After Initial Phase of Excavation
View to Northwest



PLATE 110
Overview of Area Containing Well Feature
View to West



PLATE 111
Top of Well Feature Prior to Excavation



PLATE 112
Well Feature After First Bisection
View to South



PLATE 113
Top Half of Well Feature After Initial Excavation
View to Southeast



PLATE 114
Well Feature After Partial Excavation
View to Southeast

PLATE 116
Machine Excavation of Soil Around Well Feature
View to Southeast



PLATE 115
South Profile of Well Feature after Second Bisection





PLATE 117
Plan View of Well Feature After Excavation of Northwest Quadrant
Base of Well



PLATE 118
East Profile of Northeast Quadrant of Well Feature
Base of Well



PLATE 119
Plan View of Well Feature After Second Bisection



PLATE 120
Well Feature After Removal of Upper Section and Log Pump
View to South



PLATE 121
Well Feature at the Base of Excavation
View to South



PLATE 122
Wooden Rings at Base of Well Feature
View to South



PLATE 123
Bored Log Pipe from Well Feature
Without Top Portion



PLATE 124
Base of Bored Log Pipe
Showing Wooden Plug and Nail Holes



PLATE 125
Top Section of Well Feature Pump



PLATE 126
Bored Log Pipe with Top Section of Well Feature Pump

APPENDIX II
Scope of Work

Scope of Work
for
Archaeological Evaluation
and **Resource Management Plan**
for
1514-1524; 1600-1602 King Street
and **1602 Dechantel Street,**
Alexandria, Virginia

April 28, 2006

Introduction

The goal of this scope of work is to determine if significant archaeological resources are present within the project area. In the early 19th century, the project area was located adjacent to the Virginia Tavern; however, it is not until the mid 19th century that we find the first documentary evidence of buildings within the project area. In 1850, Lucien Peyton leased the parcels of land containing 1514-1524 King Street to Edward Home, a slave dealer. Home purchased the land in 1851 and land tax records for that year suggest that he made improvements to the property at this time. These improvements are described in an Alexandria Gazette advertisement when Home put the property up for sale later that year. The advertisement describes a "recently built" brick "negro jail," a frame dwelling, a cultivated garden, a water pump, and several outbuildings.

A Documentary Study has been completed for the property. This Scope of Work is for conducting the Archaeological Evaluation. The investigations will include the excavation of machine backhoe trenches to determine if archaeological resources are actually present. If significant features are encountered (excluding deep shaft features), this Scope of Work calls for their evaluation and if deemed necessary, excavation. If a significant site or sites are discovered as a result of the field work, the sites must be registered with the Virginia Department of Historic Resources.

All aspects of this investigation will adhere to OSHA regulations and will comply with the *City of Alexandria Archaeological Standards* dated January 1996 and the *Secretary of the Interior's Standards and Guidelines for Archaeology and Historic Preservation*. Miss Utility must be informed before excavations are made. All open excavation units will be fenced when no personnel are present.

Archaeological Testing

The archeological excavation plan consists of excavating exploratory backhoe trenches of varying length across the property to determine if intact buried ground surfaces and features are present. Locations of the trenches were established in consultation with Pam Cressey, Alexandria City archaeologist and take into account information gathered from the documentary study (Exhibit 1). The total number of trenches will not exceed eleven (11).

All trenches will be five feet in width and will be excavated with a machine backhoe outfitted with a smooth blade bucket. The purpose of these trenches will be to locate intact ground surfaces and features. At least one soil strata column profile will be drawn for every trench. Photographs will be taken. Trenches will be back filled after recordation of the soil profiles if features/buried surfaces are not located. In trenches where features occur, the excavations will be expanded if necessary to allow for safe hand excavation and evaluation.

If the event that features or pre-20th-century ground surfaces are encountered, additional work will be needed to access the significance of the findings. Decisions regarding the significance of features and the need for additional testing will be made in consultation with Alexandria Archaeology. The features discovered during this process will be drawn and photographed and if deemed necessary, excavated. The additional work may involve a combination of trench expansion and hand excavation of 5 x 5 foot square test units. The trench expansion may involve stripping of larger area to expose significant features. **The additional work will be billed to the client on a per test unit basis.** Refer to the Test Unit Excavations section below.

The cost proposal does not include the excavation of any "deep shaft" features, i.e. wells or privies, which may be encountered. Depending on the size and nature of these features, this may be added as an additional service.

Test Unit Excavations: If warranted, test units (5 x 5 feet) will be excavated as part of this scope to test potentially significant archaeological features and buried ground surfaces. The test units will be excavated stratigraphically and all soil will be screened through 1/4-inch mesh hardware cloth screens. Soil profiles will be made of representative units, with soil colors described using the Munsell Soil Color Chart designations. Artifacts will be bagged and labeled by unit number and by soil horizon. The work will be documented with field notes, sketch plans, photographs, and slides. Any features encountered will be mapped and made available for inspection by Alexandria Archaeology. **Since it is not known if the test units will be necessary, they will be budgeted on a per-unit basis.**

Archival Research: Archival and historic research will provide context for the archeological work by examining:

1. History of the Virginia House Tavern
2. History on the buying and selling of slaves by informal methods (through taverns and other places) in Alexandria.

Laboratory Work and Curation

Archaeological artifacts recovered from the project area will be cleaned, stabilized (if necessary), cataloged, labeled and packaged in accordance with the guidelines set forth in the *City of Alexandria Archaeological Standards*. Organic materials that may require conservation may be recovered; however, **the cost proposal will not include conservation services.** Conservation may be added as an additional service.

At the conclusion of the project, all original photographs, negatives, slides, digital images, videotapes, copies of historical documents, field notes and forms (original copy and a duplicate copy), other field records, as well as the artifacts if they are to be donated to the City, will be delivered to Alexandria Archaeology. Archaeological collections recovered as a result of the Alexandria Archaeology Resource Protection Code must be curated at a facility which meets Federal standards for archaeological curation and collections management as described by 36CFR Part 79. The Alexandria Archaeology Storage Facility meets these standards, and the property owner is encouraged to donate the artifact collection to the City for curation. The archaeological consultant is responsible for arranging for the donation of the artifacts with the owner and will deliver the artifacts and signed forms to the appropriate storage facility.

Archaeological Evaluation Report

The Archaeological Evaluation Report will include the following: a public summary; the results of the archival and documentary research, a map of the project area; a map with unit locations and significant features; a summary of the procedures; results of the field investigation and artifact analysis, including a distribution map or other graphics which indicate potentially significant archaeological areas; an integration of the field and analysis data with the historical record.

If the investigation results in the discovery of features that require additional archaeological work, the Archaeological Evaluation Report will include a Resource Management Plan. The Resource Management Plan will present a strategy, scope of work (including a map indicating locations of proposed work in relation to completed tests), and budget for further investigations. All archaeological sites discovered will be registered with the Virginia Department of Historic Resources and copies of the registration forms will be submitted to Alexandria Archaeology.

When the fieldwork is completed, one copy of the full Archaeological Evaluation Report will be submitted to Alexandria Archaeology as a draft for review. Once the report is approved by the City Archaeologist, revisions will be made, and four copies of it, one unbound with original graphics, will be submitted to Alexandria Archaeology. The report will also be submitted on a CD. All site maps and drawings must be inked or computer-generated so as to produce sharp and clear images that will result in clear photocopies or microfilms.

Public Interpretation

The *City of Alexandria Archaeological Standards* require that a public summary be prepared as part of an Archaeological Evaluation Report. The public summary will be approximately 4 to 8 pages long with a few color illustrations. This should be prepared in a style and format that is reproducible for public distribution and use on the City's web site. Examples of these can be seen on the Alexandria Archaeology Museum website. A draft of the summary should be submitted to Alexandria Archaeology for review along with the draft of the Archaeological Evaluation Report. Upon approval, a master copy (hard copy as well as on CD or computer disk) will be submitted to Alexandria Archaeology. The summary and graphics should also be

e-mailed to Alexandria Archaeology for publication on our web site.

In addition, if determined to be warranted by the City Archaeologist, the developer will be required to erect a historical marker on the property. The archaeological consultant will supply the written text and graphics for the marker. The text should be up to 200 words in length with a paragraph on the historical significance of the site and a paragraph on findings from the archaeological investigation. The graphics (minimally four, with captions) need to be high-quality copies (scanned at a minimum of 600 dpi and saved separately as jpeg or tiff files) of line drawings (*e.g.*, site maps, feature drawings), historic photographs and maps, or other illustrations (*e.g.*, site or artifact photos) in black and white or color. All copyright releases need to have been obtained and credit provided for each graphic. The text and graphics must be submitted to Alexandria Archaeology on a CD. Coordinate with the City Archaeologist before writing the text and selecting images.

Tasks

The following is a summary of the tasks to be completed:

1. Notify Alexandria Archaeology of the field work start date. Conduct the field investigation. Alexandria Archaeology staff will conduct site inspections throughout the course of the field work to facilitate decision making regarding number and placement of units.
2. Process all significant artifacts and complete the analysis.
3. Produce and submit one draft Archaeological Evaluation Report to Alexandria Archaeology, including the public summary document and the text and graphics for the historic marker. If further archaeological investigations are necessary, the evaluation report can be a letter report to accompany the Resource Management Plan with the final report and marker text produced after all field work is completed.
4. Deliver to Alexandria Archaeology four copies and CD of the final report, final versions and CDs of the public summary and historic marker text and graphics, plus all field notes, copies of historic documents, photographs, slides, digital images, cassette tapes, transcriptions, forms and associated records. In addition, arrange for the donation and delivery of the artifacts to an appropriate storage facility. Alexandria Archaeology is the preferred repository and requires a City of Alexandria Deed of Gift form.

Formats for Digital Deliverables:

- | | |
|--------------------------------|--|
| 1. Photographs: | .jpg. |
| 2. Line Drawings: | .gif or .jpg as appropriate. |
| 3. Final Report/Public Summary | Word, PageMaker and/or PDF |
| 4. Oral History | Word |
| 5. Catalogue: | Word, Access or Excel |
| 6. Other Written material: | Word, Access, Excel, PageMaker or PDF as appropriate |

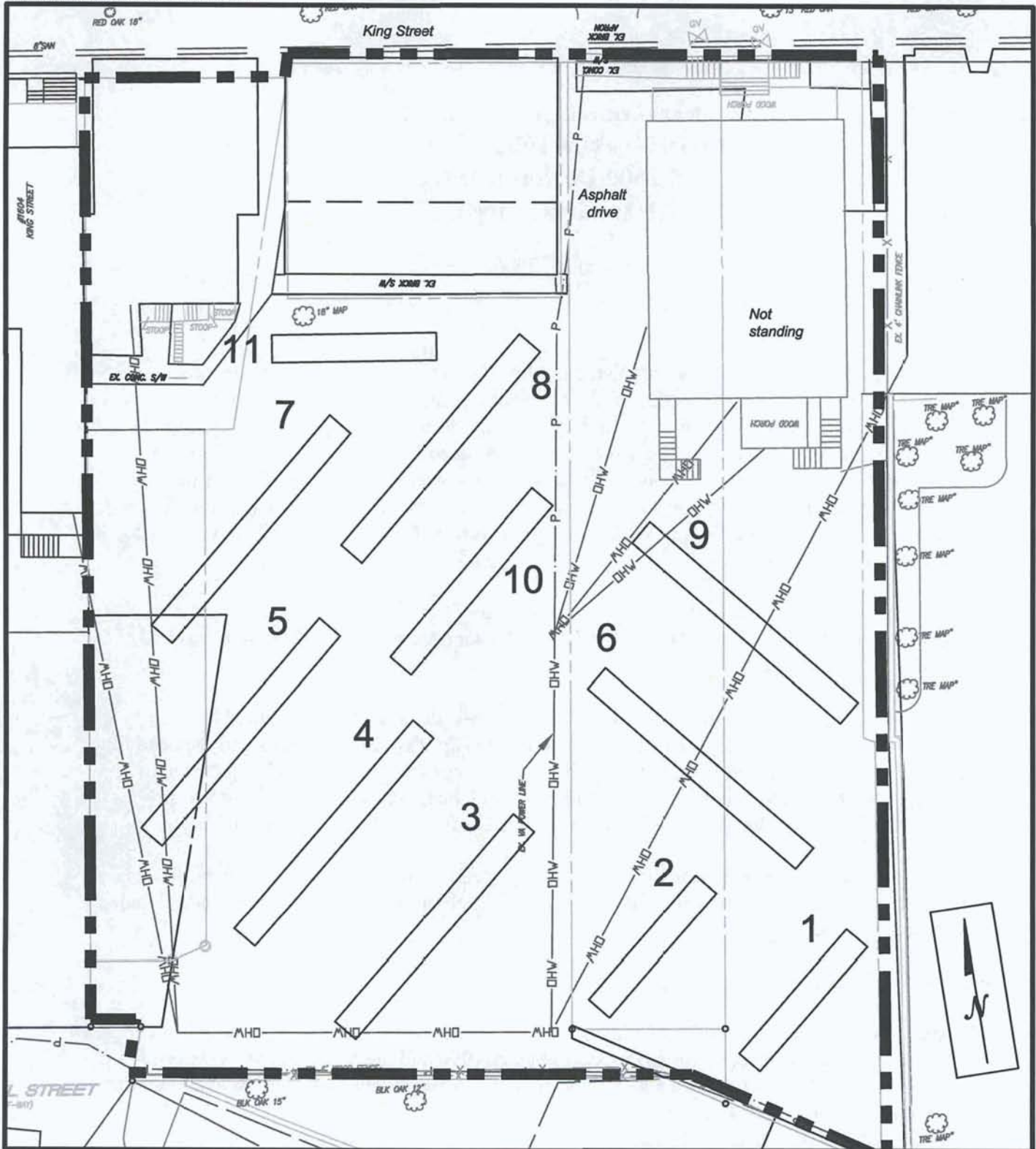

**Location of Proposed Backhoe Trench Excavation
King Street Properties
Scale 1" = 25'**

Scope of Work

Additional Archeological Investigations of 1514-1524; 1600-1602 King Street and 1602 Dechantel Street, Alexandria, Virginia

June 5, 2006

Introduction

Initial archeological investigations completed in May 2006 at the 0.61-acre parcel located between 1514 and 1602 King Street and at 1602 Dechantel Street in Alexandria, Virginia resulted in archeological evidence of the mid 19th century domestic occupation of the property. Although, the machine trenching revealed extensive and deep fill deposits across the project area, two 19th century features were located that have high research potential. The barrel well and pump (Feature 15) that was located in Trench 6 and the cobblestone feature (Feature 5), which may be a cobblestone floor or walkway, may be related to features described in the 1851 newspaper advertisement.

Because of the research potential and possible significance to understanding the domestic occupation in the middle 19th century of this end of Alexandria, further archeological work is recommended in these areas.

The previous Scope of Work (dated April 28, 2006 and revised May 1, 2006) called for consultation with Alexandria Archaeology regarding the significance of features and the need for additional testing. This additional work would involve a combination of trench expansion or stripping of larger area to expose significant features and the hand excavation of 5 x 5 foot square test units. The additional work was to be billed to the client on a per test unit basis.

The previous scope did not include the excavation of "deep shaft" features, i.e. wells or privies, nor for the conservation of artifacts. The goal of this Scope of Work is to outline the additional archeological work.

Additional Archaeological Testing

All aspects of this investigation will adhere to OSHA regulations and will comply with the *City of Alexandria Archaeological Standards* dated January 1996 and the *Secretary of the Interior's Standards and Guidelines for Archaeology and Historic Preservation*. All open excavation units will be fenced when no personnel are present.

The archeological excavation plan consists of stripping two excavation blocks in the western and eastern central portions of the project area (**Exhibit A**). The first block will be excavated over the cobblestone feature and will measure roughly 40 by 50 feet or a maximum of 2075 square feet. The block will be excavated to the depth of the cobblestones or roughly 3.5 feet

below the current ground surface. The entire feature will be mapped, photographed and evaluated. Test Unit(s) will be excavated over the cobblestone feature and additional features, such as post holes, will be excavated.

The second block excavation will explore the vicinity of the well feature, covering 35 by 50 feet (maximum of 1860 square feet). This second block will be mechanically excavated to a depth of roughly 5 feet below ground surface. At this time, the well will also be excavated.

Additional features are expected in the unexplored area between the two known features. A 50 by 5 foot machine backhoe trench (Trench 10) will be excavated in this area (see Exhibit A).

At the conclusion of archeological investigations, all excavation blocks will be backfilled.

Test Unit Excavations: At least one test unit, measuring five feet square (5 by 5 feet) will be excavated as part of this scope to test the potential buried ground surfaces. The test units will be excavated stratigraphically and all soil will be screened through 1/4-inch mesh hardware cloth screens. Soil profiles will be made of representative units, with soil colors described using the Munsell Soil Color Chart designations. Artifacts will be bagged and labeled by unit number and by soil horizon. The work will be documented with field notes, sketch plans, photographs, and slides. Any features encountered will be mapped and made available for inspection by Alexandria Archaeology.

Archival Research: Archival and historic research will provide context for the archeological work by examining:

1. water service in early Alexandria
2. technology of bored log pipes and water pumps

Laboratory Work and Curation

Archaeological artifacts recovered from the project area will be cleaned, stabilized (if necessary), cataloged, labeled and packaged in accordance with the guidelines set forth in the *City of Alexandria Archaeological Standards*.

At the conclusion of the project, all original photographs, negatives, slides, digital images, videotapes, copies of historical documents, field notes and forms (original copy and a duplicate copy), other field records, as well as the artifacts if they are to be donated to the City, will be delivered to Alexandria Archaeology. Archaeological collections recovered as a result of the Alexandria Archaeology Resource Protection Code must be curated at a facility which meets Federal standards for archaeological curation and collections management as described by 36CFR Part 79. The Alexandria Archaeology Storage Facility meets these standards, and the property owner is encouraged to donate the artifact collection to the City for curation. The archaeological consultant is responsible for arranging for the donation of the artifacts with the owner and will deliver the artifacts and signed forms to the appropriate storage facility.

Archaeological Evaluation Report

The Archaeological Evaluation Report will include the following: a public summary; the results of the archival and documentary research, a map of the project area; a map with unit locations and significant features; a summary of the procedures; results of the field investigation and artifact analysis, including a distribution map or other graphics which indicate potentially significant archaeological areas; an integration of the field and analysis data with the historical record.

When the fieldwork is completed, one copy of the full Archaeological Evaluation Report will be submitted to Alexandria Archaeology as a draft for review. Once the report is approved by the City Archaeologist, revisions will be made, and four copies of it, one unbound with original graphics, will be submitted to Alexandria Archaeology. The report will also be submitted on a CD. All site maps and drawings must be inked or computer-generated so as to produce sharp and clear images that will result in clear photocopies or microfilms.

Public Interpretation

The *City of Alexandria Archaeological Standards* require that a public summary be prepared as part of an Archaeological Evaluation Report. The public summary will be approximately 4 to 8 pages long with a few color illustrations. This should be prepared in a style and format that is reproducible for public distribution and use on the City's web site. Examples of these can be seen on the Alexandria Archaeology Museum website. A draft of the summary should be submitted to Alexandria Archaeology for review along with the draft of the Archaeological Evaluation Report. Upon approval, a master copy (hard copy as well as on CD or computer disk) will be submitted to Alexandria Archaeology. The summary and graphics should also be e-mailed to Alexandria Archaeology for publication on our web site.

In addition, if determined to be warranted by the City Archaeologist, the developer will be required to erect a historical marker on the property. The archaeological consultant will supply the written text and graphics for the marker. The text should be up to 200 words in length with a paragraph on the historical significance of the site and a paragraph on findings from the archaeological investigation. The graphics (minimally four, with captions) need to be high-quality copies (scanned at a minimum of 600 dpi and saved separately as jpeg or tiff files) of line drawings (*e.g.*, site maps, feature drawings), historic photographs and maps, or other illustrations (*e.g.*, site or artifact photos) in black and white or color. All copyright releases need to have been obtained and credit provided for each graphic. The text and graphics must be submitted to Alexandria Archaeology on a CD. Coordinate with the City Archaeologist before writing the text and selecting images.

Tasks

The following is a summary of the tasks to be completed:

1. Notify Alexandria Archaeology of the field work start date. Conduct the field investigation. Alexandria Archaeology staff will conduct site inspections throughout the course of the field work to facilitate decision making regarding number and placement of units.
2. Process all significant artifacts and complete the analysis.
3. Produce and submit one draft Archaeological Evaluation Report to Alexandria Archaeology, including the public summary document and the text and graphics for the historic marker.
4. Deliver to Alexandria Archaeology four copies and CD of the final report, final versions and CDs of the public summary and historic marker text and graphics, plus all field notes, copies of historic documents, photographs, slides, digital images, cassette tapes, transcriptions, forms and associated records. In addition, arrange for the donation and delivery of the artifacts to an appropriate storage facility. Alexandria Archaeology is the preferred repository and requires a City of Alexandria Deed of Gift form.

Formats for Digital Deliverables:

- | | |
|--------------------------------|--|
| 1. Photographs: | .jpg. |
| 2. Line Drawings: | .gif or .jpg as appropriate. |
| 3. Final Report/Public Summary | Word, PageMaker and/or PDF |
| 4. Oral History | Word |
| 5. Catalogue: | Word, Access or Excel |
| 6. Other Written material: | Word, Access, Excel, PageMaker or PDF as appropriate |

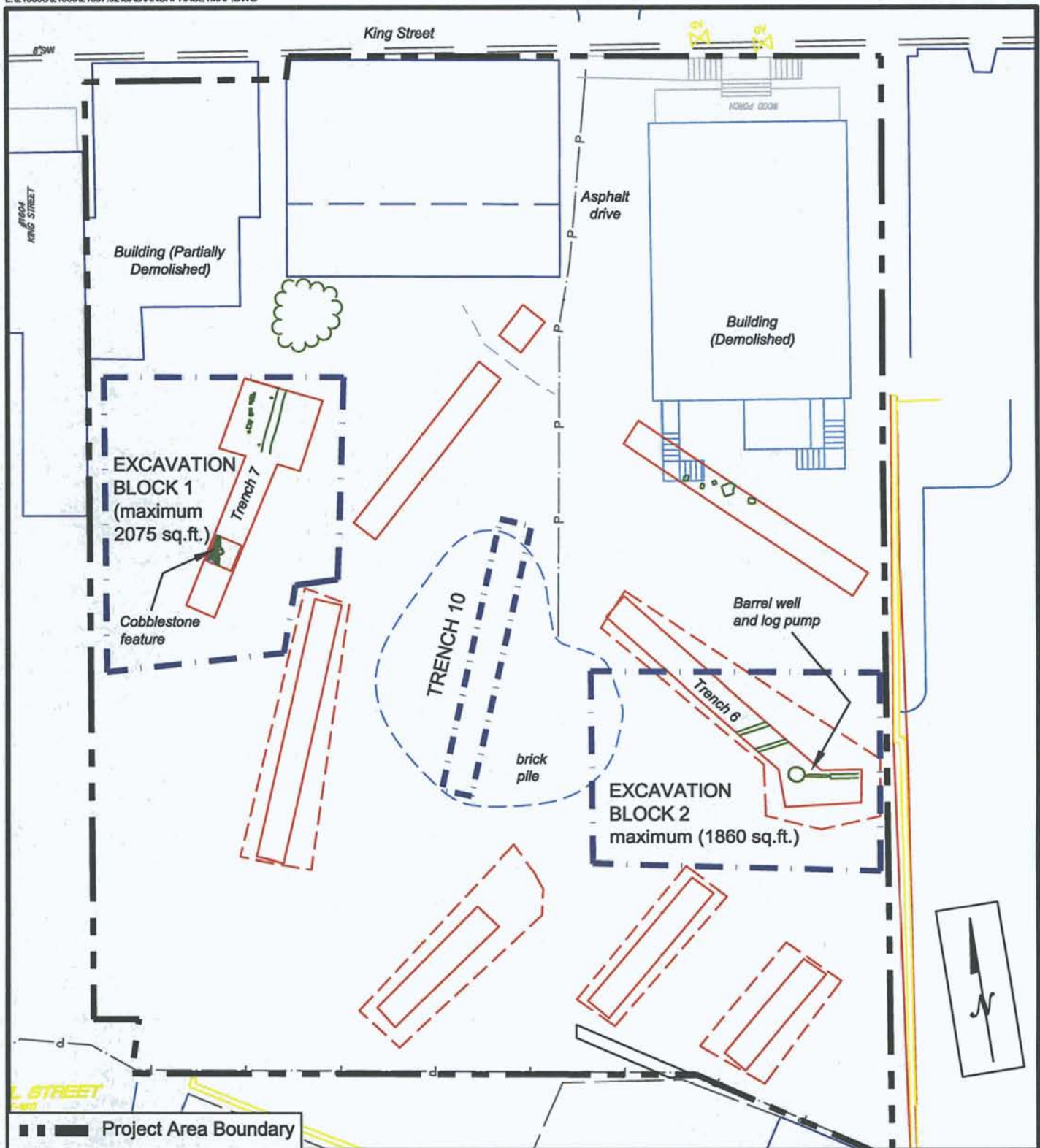

**Proposed Location of Additional Work: Excavation Blocks
King Street Properties WSSI # 21397.02
Scale 1" = 25'**

APPENDIX III
Artifact Inventory

**KING STREET PHASE I/II AND PHASE III
ARTIFACT INVENTORY**

General Surface Collection

Glass

- 1 clear cylindrical entire bottle, embossed on shoulder "F.W. BRAUNER/
ALEXANDRIA, VA." crown cap lip, automatic bottle machine (1910-
present)
- 1 pale green cylindrical entire bottle, embossed on side "PABST
MILWAUKEE", embossed on heel "THIS BOTTLE/ NOT TO BE
SOLD", embossed on base "W F & S/ X/ MIL", crown cap lip, Pabst
Brewing Co., Milwaukee, Wisconsin, (post-1895)

Trench 01, Fill 4

Ceramics

- 1 ironstone sherd, undecorated rim fragment, hollow vessel (1840-1900+,
Miller 1992)
- 2 ironstone sherds, undecorated rim fragments (1840-1900+, Miller 1992)
- 4 whiteware sherds (mend), polychrome annular decoration, base
fragment, stamped maker's mark on base lion and unicorn
"STAFFORDSHIRE ENGLAND" (1820-1900+, South 1977; 1830-
1875+, Miller 1992)

Glass

- 1 aqua oval almost entire bottle, embossed on base "96 3", automatic
bottle machine (1907-present)
- 1 clear cylindrical bottle sherd, almost entire, base missing, embossed on
side "E.R. DURKEE & CO./ SALAD DRESSING/ NEW YORK,
continuous screw threaded lip, automatic bottle machine (1910-present)
- 1 clear cylindrical entire bottle, embossed "HAYNER/ WHISKEY/
DISTILLERY/ TROY, OHIO" on side, embossed "DESIGN
PATENTED [208 inside diamond] NOV. 30TH 1897", automatic bottle
machine (1910-present)
- 1 clear oval bottle sherd, almost entire, prescription lip
- 1 clear oval entire flask, embossed on front "WARRANTED/ FLASK"
embossed on base "O. D." double collared lip
- 1 orange amber cylindrical entire bottle, embossed on side "TRADE
[embossed eagle] MARK/ THE BERGNER & ENGEL BREWING CO./
WASHINGTON, D.C. REGISTERED" embossed on base "1899",
crown cap lip (post-1890)

Miscellaneous

- 1 bone fragment
- 1 coal fragment

Trench 01, Upper 2' of Fill

Glass

- 1 light green cylindrical bottle sherd, embossed "A.G.HE..." on shoulder,
crown cap lip, automatic bottle machine (1907-present)

Trench 02, Feature 16

Ceramics

- 1 ironstone sherd, undecorated (1840-1900+, Miller 1992)
- 1 whiteware sherd, undecorated (1820-1900+, South 1977; Miller 1992)

Trench 02, Feature 17

Metal

- 4 brass fragments and cork/felt (?), lid or cap

Trench 02, Fill 4, Approx. 2.0' - 3.0' BGS

Ceramics

- 5 ironstone sherds (mend), shadow decal decoration, handle fragment, hollow vessel (1890-present, Miller 1992)

Glass

- 1 aqua cylindrical bottle sherd, small bottle, base fragment

Metal

- 1 brass ring, flat on one side, possible buckle fragment

Miscellaneous

- 1 leather fragment, thin, with holes, probably belt fragment

Trench 03, Approx. 4.5' BGS, Ashy cinder fill

Ceramics

- 2 buff bodied coarse stoneware sherds (mend), rim with handle, clear glazed interior and exterior, hollow vessel
- 1 hard paste porcelain sherd, green decal decoration, base fragment, flat vessel (post-1890, "Miller 1992)
- 1 whiteware sherd, blue transfer printed, rim with handle fragment, hollow vessel (1820-1900+, South 1977; 1830-1865+, Miller 1992)

Glass

- 1 aqua oval entire bottle, flask (?), tapered lip, possibly tooled, opalized
- 1 aqua rectangular entire bottle, small, collared lip, automatic bottle machine (1907-present)
- 1 clear cylindrical entire bottle, ketchup/sauce bottle, embossed on base "H. J. HEINZ CO. PAT(?) / 162", automatic bottle machine (1910-present)
- 2 clear oval entire bottles, embossed triangle on base, possibly tooled lip, one slightly larger than the other
- 1 clear rectangular entire bottle, small, embossed "11" on shoulder, possibly chilled iron mold
- 1 clear square entire bottle, small, continuous screw threaded lip, stained, automatic bottle machine (1910-present)
- 1 green cylindrical bottle sherd, narrow, base fragment with kick-up, probable wine bottle, stained
- 1 light aqua entire square ink well, embossed "CAW'S INK/ NEW YORK" (post-1886)
- 1 light green cylindrical bottle sherd, almost complete, lip missing, possibly turn mold olive oil bottle
- 1 light greenish-aqua square entire bottle, possibly chilled iron mold

- 1 very pale green oval entire bottle, small, possible shoe shine bottle, non-continuous screw threaded lip, embossed on neck "2 FL. OZ." embossed on base "PAT. 83892/ 14", unidentified white substance in bottle, automatic bottle machine (1910-present)

Trench 03, Approx. 7.0' BGS

Glass

- 2 amber cylindrical bottle sherds (mend), embossed "Arlingto.../ Brewing Co./ ROSSLYN, VA.", Arlington Bottling Co. (1886-1941)
- 2 clear cylindrical entire bottle sherds (mend), embossed on side "ANHEUSER BUSCH BREW ASSN./ REGISTERED" embossed on base "B.R.G. Co.", crown cap lip, chilled iron mold (1890-1930)
- 1 teal/peacock entire bottle, 8-sided, embossed on side "W/ RUMFORD CHEMICAL WORKS", embossed on base "PATENTED MARCH 10, 1868", Horsford's Acid Phosphate, tonic concentrate (1868-1907)

Trench 03, GSC

Glass

- 1 light aqua square/rectangular bottle sherd, embossed "DR. KILMER'S SWAMP ROOT/ KIDNEY LIVER/ AND BLADDER REMEDY/ BINGHAMTON. NY. U.S.A." (post-1906)

Trench 04, Fill 3

Glass

- 1 clear oval entire bottle, embossed "MALLARD DISTILLING Co/BALTIMORE AND NEW YORK/PATENT APPLIED FOR"
- 1 NEEDS TO BE FINISHED light green cylindrical entire bottle, embossed on body "TRADE [F inside diamond] REGISTERED/ F. H. FINLEY & SON/ 1894-1902/ BOTTLERS/ 208-10-12 MASS.AVE.N.E./ WASHINGTON, D.C./ THIS BOTTLE/ NOT TO BE SOLD" embossed on base ...
- 1 pale aqua cylindrical entire bottle, embossed on shoulder "RUMFORD", embossed "119" on base, single banded collared lip, opalized
- 1 pale aqua cylindrical entire bottle, embossed on side "DARLEY PARK/ BREWERY/ G.B.S. (in block script letters)", embossed on heel "BALTIMORE, MD.", crown cap lip, automatic bottle machine (1907-present)
- 1 pale green cylindrical entire bottle, embossed on shoulder "ROBERT ... BREWING CO./ TRADE MARK TRIVIOLI [inside diamond]/ ALEXANDRIA , VA.", crown cap lip, automatic bottle machine (1907-present)

Trench 04, from North Wall Profile at 25', Fill 2

Ceramics

- 2 whiteware sherds (mend), flow blue transfer printed, rim fragments (1820-1900+, South 1977; 1835-1870+, Miller 1992)

Trench 06, East End, Approx. 3' BGS

Ceramics

- 2 ironstone sherds, (mend) brown transfer printed, base fragment, hollow

vessel (1840-1900+, Miller 1992)

Glass

- 1 amber cylindrical entire bottle, embossed "Coca-Cola WASHINGTON, D.C." around heel, embossed "O.B.CO." on base, crown cap lip, automatic bottle machine (1907-present)
- 1 aqua oval bottle sherd, opalized
- 2 aqua oval bottle sherds (mend), embossed "...E. PINKHAM'S/ ...BLE COMPOUND" on body, embossed "M/6" or "9/W" on base
- 1 clear rectangular entire bottle, lip missing, embossed "W.T. CO./ WTCT/U.S.A." on base, chilled iron mold (1880-1930)
- 2 clear selenium (grey) oval bottle sherds (mend), embossed triangle on base (1911-1930)
- 1 clear square/rectangular bottle sherd, possibly clear selenium (yellow)

Miscellaneous

- 1 leather shoe fragment, wire nails/tacks, child's size
- 1 unidentified leather fragment

Trench 06, East End, Fill 2

Ceramics

- 1 hard paste porcelain doll plate, undecorated
- 1 whiteware sherd, polychrome decal decoration (1820-1900+, South 1977; 1890-present, Miller 1992)

Glass

- 4 clear cylindrical bottle sherds (mend), embossed "JAS McC.../ ALEXANDRIA ...", crown cap lip (post-1890)
- 1 clear cylindrical bottle/jar sherd

Metal

- 2 ferrous metal possible spout fragments
- 1 unidentified ferrous metal fragment
- 6 unidentified nail fragments, some pulled

Miscellaneous

- 1 cinder fragment
- 3 peach pits

Trench 06, East End, Fill 3/4 Interface

Glass

- 2 clear rectangular entire bottle with stopper, embossed on side "FAIRFAX & CO./ ALEXANDRIA, VA.", embossed "00" or "DD" on base, tapered lip with collar
- 2 light green cylindrical entire bottle, embossed "TRADE [F inside diamond] MARK REGISTERED/ F.H. FINLEY & SON/ 1894-1902/ BOTTLERS/ 208-10-12-MASS. AVE.N.E./ WASHINGTON D.C./ THIS BOTTLE NOT TO BE SOLD", embossed with trade mark on base (1894-1902)

Metal

- 1 ferrous metal spring

Miscellaneous

- 4 cork fragments
- 1 unidentified lead or graphite rod fragment

Trench 07, Associated with Utility Pole, Approx. 3.5' BGS

Glass

- 1 aqua insulator fragment, threaded
- 3 aqua rectangular bottle sherds (mend), embossed "...LLEN'S" on side panel, base fragment, opalized
- 1 light aqua entire cylindrical bottle, embossed "AB/ T 11" on base, crown cap lip, automatic bottle machine (1907-present)
- 1 light aqua small rectangular bottle sherd, opalized
- 1 pale green entire cylindrical bottle, embossed "Arlington Bottling Co./ Chas Jacobson Prof./ Washington, D.C./ Registered/ THIS BOTTLE NOT TO BE SOLD", crown cap lip, Arlington Bottling Co. (1886-1941), automatic bottle machine (1907-1941)

Trench 08, Feature 1, 2.7' BGS

Ceramics

- 1 buff bodied coarse stoneware sherd, Bristol glazed interior and exterior, stamped on heel "GROSVENOR (?) GLASGOW", bottle base
- 1 whiteware sherd, polychrome decal, rim fragment (1820-1900+, South 1977; 1890-present, Miller 1992)

Glass

- 1 amber oval bottle sherd, base fragment, embossed "608" inside diamond, automatic bottle machine (1907-present)
- 1 light aqua rectangular bottle sherd, base fragment embossed "C", embossed "CAST..." on side

Metal

- 2 wire nail fragments (1890-present)

Miscellaneous

- 1 slate fragment, possible roofing tile

Trench 10, 3' BGS

Glass

- 1 amber entire cylindrical bottle, crown cap lip, embossed "Coca-Cola/ BOT. WKS./ WASHINGTON, D.C./ TRADE MARK REGISTERED" around shoulder, embossed "ROOT" on base, pressed horizontal linear pattern around heel, automatic bottle machine (1907-present)
- 1 amber entire cylindrical small bottle, embossed "Lysol" around shoulder four times, embossed "LYSOL INCORPORATED BLOOMFIELD, N.J./ BOTTLE MADE IN U.S.A. [triangle in center]" on base, automatic bottle machine (1907-present)
- 1 clear cylindrical small jar sherd, almost complete, pressed, screw threaded lip, probably salt/pepper shaker, automatic bottle machine (1910-present)
- 1 clear oval entire flask, possible tooled lip, embossed "WARRANTED/ FLASK" on front, embossed "J" on base, possibly chilled iron mold

- 1 cobalt entire cylindrical bottle, embossed "KEASBEY & MATTISON Co.
AMBLER, PA" around shoulder, possible tooled lip, opalized
- 1 cobalt entire cylindrical small bottle, embossed "BROMO-SELTZER/
EMERSON/ DRUG CO./ BALTIMORE MD", automatic bottle machine
(1907-present)

Trench 10, Black Fill

Ceramics

- 1 ironstone sherd, undecorated, black maker's mark on base, two people with shield and eagle, banner with unidentified writing below, "IRONSTONE CHIN...", base fragment, stained, Maryland Queensware Company (post-1879)

Metal

- 1 U.S. brass small one cent, Indian head, shield on reverse (1866)

44AX0202

Block 1, Feature 5, Sample from Above Feature 5

Ceramics

- 1 buff bodied coarse stoneware sherd, unglazed interior and exterior
- 1 hard paste porcelain sherd, undecorated, rim fragment
- 4 ironstone sherds (mend), black maker's mark, lion and unicorn, "STONE CHINA/ [J]AMES EDWARDS & SON/ DALEHALL" (1851-1882, Godden 1991)
- 4 ironstone sherds, undecorated (1840-1900+, Miller 1992)
- 3 ironstone sherds, undecorated base fragments (1840-1900+, Miller 1992)
- 4 pearlware sherds (mend), polychrome hand painted, lid fragment (1795-1815, South 1977; 1780-1835, Miller 1992)
- 1 refined white earthenware sherd, undecorated rim/base fragment, flat vessel, stained, probably ironstone
- 2 refined white earthenware sherds, undecorated base fragments, stained
- 1 whiteware sherd, black maker's mark, banner "GRANITE" underneath banner "W. ADAMS & SON" (1820-1900+, South 1977; Miller 1992)
- 1 whiteware sherd, green rim band, rim fragment (1820-1900+, South 1977; Miller 1992)
- 1 whiteware sherd, polychrome hand painted, base fragment (1820-1900+, South 1977; 1825-1860+, Miller 1992)
- 1 whiteware sherd, undecorated (1820-1900+, South 1977; Miller 1992)
- 1 whiteware sherd, undecorated base fragment (1820-1900+, South 1977; Miller 1992)
- 1 whiteware sherd, unidentified blue decoration (1820-1900+, South 1977; Miller 1992)
- 1 whiteware sherd, unidentified blue/purple transfer printed or flow blue, rim fragment (1820-1900+, South 1977; Miller 1992)

- 3 whiteware sherds (mend), blue annular decoration, rim fragments, hollow vessel (1820-1900+, South 1977; 1830-1875+, Miller 1992)
- 3 whiteware sherds (mend), blue transfer printed, base fragments, flat vessel (1820-1900+, South 1977; 1830-1865+, Miller 1992)
- 3 whiteware sherds (mend), blue transfer printed, rim fragments, flat vessel (1820-1900+, South 1977; 1830-1865+, Miller 1992)
- 2 whiteware sherds, blue transfer printed (1820-1900+, South 1977; 1830-1865+, Miller 1992)
- 2 whiteware sherds, polychrome hand painted, rim fragments (1820-1900+, South 1977; 1825-1860+, Miller 1992)
- 4 whiteware sherds, undecorated rim fragments, flat vessels (1820-1900+, South 1977; Miller 1992)
- 1 yellowware sherd, undecorated rim fragment (1830-1940, Miller 1992)

Glass

- 2 clear cylindrical bottle/jar sherds, thin, stained
- 1 dark olive green cylindrical bottle sherd, neck fragment, possibly contact mold
- 1 greenish-aqua cylindrical bottle sherd, worn
- 1 olive green cylindrical bottle sherd, stained
- 1 unidentified very pale green sherd, flat, possible soda windowpane

Metal

- 2 cut nail fragments (post-1790)
- 4 unidentified nail fragments
- 1 wire nail fragment (1890-present)

Miscellaneous

- 1 bone fragment
- 1 coal fragment
- 1 slate roofing fragment

Block 1, Feature 5, Within Cobble Layer

Ceramics

- 1 American Rockingham/Bennington sherd, undecorated, handle fragment (1800-1912, Miller 1992)
- 2 American Rockingham/Bennington sherds (mend), rouletting decoration, rim/handle fragments (1800-1912, Miller 1992)
- 4 American Rockingham/Bennington sherds, engine turned (1800-1912, Miller 1992)
- 5 American Rockingham/Bennington sherds, undecorated (1800-1912, Miller 1992)
- 1 buff and grey bodied coarse stoneware sherd, clear salt glazed interior, clear glaze exterior
- 1 buff bodied stoneware sherd, clear salt glazed
- 1 grey bodied coarse stoneware sherd, cobalt hand painted and clear salt glazed exterior, clear glazed interior
- 2 grey bodied coarse stoneware sherds, clear glazed interior and exterior
- 1 hard paste porcelain sherd, undecorated, base fragment

- 1 hard paste porcelain sherd, unidentified blue decoration, worn
- 6 hard paste porcelain sherds, undecorated, two stained
- 1 ironstone sherd, molded decoration, handle fragment (1840-1900+, Miller 1992)
- 1 ironstone sherd, undecorated, rim fragment (1840-1900+, Miller 1992)
- 10 ironstone sherds, undecorated (1840-1900+, Miller 1992)
- 1 kaolin pipe bowl fragment
- 1 pearlware sherd, unidentified green decoration, rim fragment
- 1 pearlware sherd, unidentified polychrome decoration
- 2 pearlware sherds, green shell edge, rim fragments (1780-1830, South 1977; 1800-1830, Miller 1992)
- 2 pearlware sherds, undecorated (1780-1830, South 1977; Miller 1992)
- 1 redware sherd, brown glazed interior
- 1 redware sherd, brown glazed interior and exterior
- 3 redware sherds, unglazed
- 1 refined redware sherd, undecorated (1800-1840, Magid 1990)
- 1 refined redware sherd, undecorated, Jackfield like (1800-1840, Magid 1990)
- 1 refined white earthenware sherd, undecorated, base fragment, flat vessel, burned/stained
- 4 refined white earthenware sherds, undecorated, burned/stained
- 1 refined white earthenware spall
- 1 soft paste porcelain sherd, undecorated, base fragment
- 2 soft paste porcelain sherds (mend), undecorated, rim fragments, stained
- 2 soft paste porcelain sherds, undecorated
- 1 whiteware sherd, blue spatter/sponge decoration (1820-1900+, South 1977; 1830-1865+, Miller 1992)
- 1 whiteware sherd, green annular decoration, rim fragment (1820-1900+, South 1977; 1830-1875+, Miller 1992)
- 1 whiteware sherd, light blue sprig molding (1820-1900+, South 1977; Miller 1992)
- 1 whiteware sherd, molded decoration, handle fragment (1820-1900+, South 1977; 1845-1885, Miller 1992)
- 1 whiteware sherd, polychrome annular decoration, rim fragment (1820-1900+, South 1977; 1830-1875+, Miller 1992)
- 1 whiteware sherd, polychrome spatter/sponge decoration, rim fragment (1820-1900+, South 1977; 1830-1865+, Miller 1992)
- 1 whiteware sherd, undecorated, base fragment, flat vessel (1820-1900+, South 1977; Miller 1992)
- 1 whiteware sherd, unidentified blue decoration, rim fragment (1820-1900+, South 1977; Miller 1992)
- 1 whiteware sherd, unidentified violet decoration, probably transfer printed, rim or base fragment (1820-1900+, South 1977; Miller 1992)
- 3 whiteware sherds, blue shell edge, rim fragments (1820-1900+, South 1977; 1830-1860+, Miller 1992)

- 2 whiteware sherds, blue transfer printed, base fragments, stained (1820-1900+, South 1977; 1830-1865+, Miller 1992)
- 5 whiteware sherds, blue transfer printed, stained (1820-1900+, South 1977; 1830-1865+, Miller 1992)
- 2 whiteware sherds, polychrome annular decoration (1820-1900+, South 1977; 1830-1875+, Miller 1992)
- 18 whiteware sherds, undecorated (1820-1900+, South 1977; Miller 1992)
- 2 whiteware sherds, unidentified polychrome decoration, rim fragment (1820-1900+, South 1977; Miller 1992)
- 2 yellowware sherds, undecorated (1830-1940, Miller 1992)
- 4 yellowware sherds, undecorated, rim fragments (1830-1940, Miller 1992)

Glass

- 1 amber cylindrical bottle sherd
- 12 Ball blue cylindrical canning jar sherds, automatic bottle machine (1909-1938)
- 9 clear cylindrical bottle/jar sherds, some stained, one base fragment
- 2 clear cylindrical tableware sherds, rim fragments, stained/worn
- 1 clear lamp chimney sherd, crimped edge
- 9 clear multi-sided bottle/tableware sherds, most stained/opalized, two base fragments
- 1 cornflower cylindrical bottle sherd, stained
- 2 dark greenish-aqua cylindrical bottle sherds, contact mold (1810-1880)
- 3 dark greenish-aqua cylindrical bottle sherds, two have unidentified embossing
- 1 green cylindrical bottle sherd, unidentified embossing, contact mold (1810-1880)
- 2 green cylindrical bottle sherds, contact mold (1810-1880)
- 1 greenish-aqua cylindrical bottle sherd, contact mold (1810-1880)
- 2 olive amber blackglass cylindrical bottle sherds, stained (pre-1880)
- 1 olive green cylindrical bottle sherd, embossed decoration upper portion of arrows, contact mold (1810-1880)
- 2 olive green cylindrical bottle sherds, stained/worn
- 1 pale aqua cylindrical bottle sherd, base fragment, pontil, worn (pre-1860)
- 9 pale aqua cylindrical bottle sherds, some stained, some thin
- 1 pale aqua cylindrical small bottle sherd, base fragment, open pontil, embossed "...E" on body (pre-1860)
- 1 pale aqua cylindrical tableware sherd, rim fragment, worn
- 2 pale aqua square/rectangular bottle sherds, thin, one stained
- 1 pale green multi-sided small bottle sherd, base fragment, pontil, stained (pre-1860)
- 2 peacock cylindrical bottle sherds, contact mold, one base fragment (1810-1880)
- 5 peacock cylindrical bottle sherds, worn
- 7 unidentified clear sherds, flat

- 5 unidentified clear sherds, some stained
- 2 unidentified dark greenish-aqua sherds, worn
- 4 unidentified green spalls
- 3 unidentified greenish-aqua sherds, curved
- 1 unidentified light olive green sherd, flat, stained
- 2 unidentified olive amber sherds
- 3 unidentified olive green spalls
- 10 unidentified pale aqua sherds
- 5 unidentified very pale aqua sherds
- 6 unidentified very pale green sherds, flat, stained, possible windowpane
- 1 unidentified white milk glass sherd, curved
- 2 very pale green cylindrical bottle sherds
- 1 white milk glass 4-hole sew through button -- 1.1 cm diameter
- 1 windowpane sherd, crown, soda (pre-1852)
- 1 windowpane sherd, soda (pre-1864)
- 20 windowpane sherds, lime soda (1864-present)
- 3 windowpane sherds, potash (pre-1864)
- 9 windowpane sherds, soda/potash (pre-1864)

Metal

- 5 unidentified ferrous metal fragments
- 10 unidentified ferrous metal fragments, probably nails

Miscellaneous

- 10 bone fragments, one tooth
- 3 coal fragments

Block 1, Test Unit 3, Level 1, Overburden

Ceramics

- 1 grey bodied coarse stoneware sherd, clear salt glazed exterior, brown glazed interior, base fragment
- 2 hard paste porcelain sherds, molded decoration, one possible base fragment
- 2 hard paste porcelain sherds, undecorated
- 4 ironstone sherds, undecorated (1840-1900+, Miller 1992)
- 1 pearlware sherd, undecorated base fragment (1780-1830, South 1977; Miller 1992)
- 1 refined white earthenware sherd, molded decorative possible lug attached, burned/stained
- 1 refined white earthenware sherd, undecorated, rim fragment, burned/stained
- 1 soft paste porcelain sherd, undecorated rim fragment
- 2 soft paste porcelain sherds, undecorated
- 1 whiteware sherd, blue shell edge, rim fragment (1820-1900+, South 1977; 1830-1860+, Miller 1992)
- 1 whiteware sherd, brown annular decoration (1820-1900+, South 1977; 1830-1875+, Miller 1992)
- 1 whiteware sherd, undecorated rim fragment (1820-1900+, South 1977; Miller 1992)

- 1 whiteware sherd, undecorated rim/base fragment, flat vessel (1840-1900+, Miller 1992)
- 1 yellowware sherd, undecorated, rim fragment (1830-1940, Miller 1992)

Glass

- 2 clear cylindrical bottle/jar sherds (mend), pontil mark on base, embossed "J & C" on heel, base fragment (pre-1860)
- 23 clear cylindrical bottle/jar sherds, probably mend, slightly stained/opalized
 - 1 light aqua cylindrical bottle sherd, unidentified embossing, opalized
 - 5 light olive green cylindrical bottle sherds
 - 3 olive green cylindrical bottle sherds
 - 3 pale aqua cylindrical bottle sherds
 - 1 peacock square/rectangular bottle sherd
 - 9 unidentified clear sherds, some opalized
 - 2 unidentified pale green sherds, flat
 - 1 white milk glass cylindrical bottle/jar sherd

Metal

- 2 cut nail fragments (post-1790)
- 8 unidentified ferrous metal fragments
- 5 unidentified ferrous metal fragments, probably nails

Miscellaneous

- 4 bone fragments
- 5 brick fragments, 48.0 grams
- 4 coal fragments
- 10 oyster shell fragments, 208.9 grams

Block 1, Test Unit 3, Level 2a

Ceramics

- 1 ironstone sherd, undecorated base fragment (1840-1900+, Miller 1992)
- 2 ironstone sherds, undecorated (1840-1900+, Miller 1992)
- 2 ironstone sherds, undecorated rim fragments (1840-1900+, Miller 1992)
- 1 kaolin pipe stem fragment
- 1 pearlware sherd, undecorated (1780-1830, South 1977; Miller 1992)
- 1 refined white earthenware sherd, unidentified blue decoration

Glass

- 2 unidentified clear sherds, curved, thin

Metal

- 3 unidentified ferrous metal fragments
- 3 unidentified ferrous metal fragments, probably nails

Miscellaneous

- 2 bone fragments
- 2 brick fragments, 1.5 grams
- 1 shell fragment, 0.3 grams
- 1 white plastic fragment

Block 1, Test Unit 3, Level 2b

Ceramics

- 1 grey and buff bodied coarse stoneware sherd, salt glazed exterior, brown glazed interior
- 1 hard paste porcelain sherd, undecorated
- 1 ironstone sherd, blue transfer printed, rim fragment (1840-1900+, Miller 1992)
- 1 ironstone sherd, undecorated rim fragment (1840-1900+, Miller 1992)
- 1 ironstone sherd, unidentified black maker's mark, base fragment (1840-1900+, Miller 1992)
- 5 ironstone sherds, undecorated base fragments, some stained (1840-1900+, Miller 1992)
- 8 ironstone sherds, undecorated, some stained (1840-1900+, Miller 1992)
- 2 kaolin pipe stem fragments
- 1 opaque porcelain sherd, rim/base, possibly small dish or utility/non-kitchen related (post-1880, Magid 1990)
- 1 redware sherd, red/brown glazed interior, unglazed exterior
- 2 refined white earthenware sherds, burned, one possible shell edge
- 2 refined white earthenware sherds, unidentified blue decoration
- 1 refined white earthenware spall
- 1 whiteware sherd, blue shell edge, rim fragment (1820-1900+, South 1977; 1830-1860+, Miller 1992)
- 1 whiteware sherd, brown transfer printed, base fragment, flat vessel (1820-1900+, South 1977; 1825-1875+, Miller 1992)
- 1 whiteware sherd, mulberry transfer printed, base fragment, tea cup (1820-1900+, South 1977; 1825-1875+, Miller 1992)
- 1 whiteware sherd, unidentified blue decoration, possibly spatter/sponge, rim/base fragment, flat vessel (1820-1900+, South 1977; Miller 1992)
- 1 yellowware sherd, white and black annular decoration, hollow vessel (1830-1940, Miller 1992)

Glass

- 4 clear cylindrical bottle/jar sherds, one stained
- 1 clear cylindrical multi-sided bottle sherd, base fragment
- 1 dark amber cylindrical bottle sherd, worn
- 1 dark aqua cylindrical bottle sherd, worn
- 8 olive green cylindrical bottle sherds
- 12 pale aqua cylindrical bottle sherds
- 5 peacock square/rectangular bottle sherds
- 1 unidentified clear sherd, curved, thin
- 2 unidentified greenish-aqua sherds
- 5 unidentified pale aqua sherds, flat, stained
- 7 windowpane sherds, lime soda (1864-present)

Metal

- 1 cut nail fragment (post-1790)
- 12 unidentified ferrous metal fragments
- 34 unidentified ferrous metal fragments, probably nails

Miscellaneous

- 11 bone fragments
- 4 brick fragments, 168.7 grams
- 1 coal fragment
- 4 oyster shell fragments, 109.1 grams

Block 1, Test Unit 3, Level 3, Under Cobble Feature

Ceramics

- 2 buff bodied coarse stoneware sherds, clear/grey salt glazed exterior, unglazed interior
- 2 pearlware sherds, blue hand painted (1780-1820, South 1977; 1780-1830, Miller 1992)
- 5 pearlware sherds, undecorated (1780-1830, South 1977; Miller 1992)
- 1 redware spall
- 2 refined white earthenware sherds, undecorated, stained, probably whiteware

Glass

- 1 olive green cylindrical bottle sherd, worn
- 4 unidentified pale aqua sherds
- 1 windowpane sherd, potash (pre-1864)
- 1 windowpane sherd, soda/potash (pre-1864)

Metal

- 3 unidentified ferrous metal fragments

Miscellaneous

- 3 brick fragments, 13.0 grams
- 1 coal fragment
- 1 shell fragment, 3.2 grams

Block 1, Test Unit 3, Level 4

Ceramics

- 1 redware spall

Glass

- 1 unidentified clear sherd, slightly curved, stained

Block 2, Feature 13 and 14, West End, Soil around Features

Ceramics

- 1 grey bodied coarse stoneware sherd, grey/light brown salt glazed exterior, brown glazed interior
- 1 grey bodied coarse stoneware sherd, light greenish salt glazed exterior, clear/grey glazed interior, bottle lip (mid-19th century)
- 1 whiteware sherd, blue transfer printed, rim fragment (1820-1900+, South 1977; 1830-1865+, Miller 1992)
- 1 whiteware sherd, polychrome annular, rim/base fragment of cup (1820-1900+, South 1977; 1830-1875+, Miller 1992)

Glass

- 1 green blackglass cylindrical bottle sherd, base fragment, embossed "VA" on heel, graphite pontil, contact mold (1810-1860)
- 1 green blackglass cylindrical bottle sherd, neck and lip fragment, applied brandy/tapered lip, probably contact mold (pre-1880)
- 1 green cylindrical bottle sherd, applied brandy/tapered lip
- 1 light green cylindrical bottle sherd, embossed partial eagle
- 2 light olive amber cylindrical bottle sherds, heated, stained
- 1 light olive green cylindrical bottle sherd
- 1 olive amber blackglass cylindrical bottle sherd, contact mold (1810-1880)
- 2 olive green blackglass cylindrical bottle sherds (mend), embossed wheat and shield on body, "...AN.../ VA" around heel, graphite pontil, contact mold (1810-1860)
- 1 windowpane sherd, soda/lime soda

Metal

- 1 unidentified ferrous metal fragment

Miscellaneous

- 1 bone fragment
- 1 leather shoe fragment
- 1 oyster shell fragment, 40.4 grams
- 1 whet stone fragment

Block 2, Feature 13, Fill under Feature

Ceramics

- 1 yellowware sherd, polychrome annular decoration, rim fragment, probably chamber pot (1830-1940, Miller 1992)

Block 2, Feature 13, Nails removed from boards

Metal

- 3 cut nail fragments (post-1790)

Block 2, Feature 13A, North Side

Glass

- 1 olive green blackglass cylindrical bottle sherd, contact mold (1810-1880)
- 1 unidentified light aqua sherd, heat melted

Miscellaneous

- 3 brick fragments, 17.9 grams

Block 2, Feature 14, In board over channel

Metal

- 1 unidentified T-head nail fragment, possibly cut or wrought

Block 2, Feature 14A, Fill 1

Miscellaneous

- 7 brick fragments, 13.4 grams
- 1 leather strap

Block 2, Feature 15, around

Metal

- 1 Civil War Springfield Steel Bayonet

Miscellaneous

- 1 corn cob fragment
- 1 root mat

Block 2, Feature 15, East Half, inside barrel, Level 2

Ceramics

- 1 buff bodied coarse stoneware sherd, grey salt glazed exterior, unglazed interior, base fragment
- 1 dark buff bodied coarse stoneware sherd, clear salt glazed exterior, brown glazed interior
- 1 grey and buff bodied coarse stoneware sherd, clear salt glazed exterior, unglazed interior, base fragment
- 3 grey and buff bodied coarse stoneware sherds, clear salt glazed exterior, unglazed interior
- 1 grey bodied coarse stoneware sherd, clear salt glazed exterior, brown glazed interior, base fragment
- 3 grey bodied coarse stoneware sherds, clear salt glazed exterior
- 2 grey bodied coarse stoneware sherds, clear salt glazed exterior, brown glazed interior, rim fragments, one with spout/lip
- 1 redware sherd, brown glazed interior and exterior
- 1 redware sherd, brown glazed interior, unglazed exterior
- 5 redware sherds (mend), base of flower pot
- 1 refined redware sherd, clear glazed interior and exterior, spout fragment (1800-1840, Magid 1990)
- 1 refined white earthenware sherd, blue transfer printed, burned/stained
- 1 refined white earthenware sherd, undecorated chamber pot rim fragment, probably creamware, stained
- 1 refined white earthenware sherd, undecorated, finial fragment, burned/stained
- 1 refined white earthenware sherd, undecorated, pie crust-style rim fragment, burned/stained
- 1 refined white earthenware sherd, undecorated, stamped maker's mark on base "HERCULANEUM", base fragment, probably pearlware, burned/stained (1793-1841, Godden 1991)
- 3 refined white earthenware sherds (2 mend), blue transfer printed rim fragments, burned/stained
- 3 refined white earthenware sherds (mend), blue transfer printed, shallow bowl rim/base fragments, burned/stained
- 2 refined white earthenware sherds, green shell edge rim fragments, probably pearlware, burned/stained
- 2 refined white earthenware sherds, green shell edge rim/base fragments, probably pearlware, burned/stained
- 2 refined white earthenware sherds, rim fragments, heavily burned/stained

- 4 refined white earthenware sherds, undecorated, base fragments, burned/stained
- 16 refined white earthenware sherds, undecorated, burned/stained
- 1 stoneware kiln waster furniture

Glass

- 1 clear oval perfume bottle, lip missing, probably acid etched, floral motif
- 3 dark olive green cylindrical bottle sherds, worn
- 1 light aqua square/rectangular bottle sherd, embossed "...H...", opalized
- 2 light green square bottle sherds (mend), base fragment, embossed "...TENT/ ...E/ ...F", hinge mold, open pontil (1815-1860s)
- 6 unidentified clear sherds, curved, thin, stained black

Metal

- 1 brass scabbard finial, gilded
- 1 brass straight pin fragment
- 1 copper flat disc button, wire eye attachment -- 2.3 cm diameter
- 2 copper flat disc buttons, wire eye attachment, unidentified writing stamped on reverse -- 1.4 cm diameter
- 1 cut nail fragment, burned (post-1790)
- 6 ferrous metal can fragments, thin (fragile)
- 1 ferrous metal horseshoe
- 1 lead shot, 1.6 cm diameter
- 1 probable brass scabbard throat, gilded
- 3 unidentified brass strips, thin
- 15 unidentified ferrous metal fragments
- 1 unidentified ferrous metal rod, probably cut, curved at center
- 1 unidentified nail fragment, L-head
- 3 unidentified thin brass/copper fragments, fragile

Miscellaneous

- 9 bone fragments, burned, some cut
- 1 brick fragment, 16.7 grams
- 3 oyster shell fragments, 19.4 grams
- 4 peach pit fragments
- 1 unidentified seed/pit
- 1 wood 4-hole sew through button, slightly burned -- 1.6 cm diameter
- 1 wood 5-hole sew through button -- 1.6 cm diameter
- 2 wood 5-hole sew through buttons, slightly burned -- 1.5 cm diameter
- 2 wood fragments
- 6 wood/cork fragments, burned (fragile)

Block 2, Feature 15, East Half, inside barrel, Level 2,

Ceramics

- 15 redware sherds, undecorated
- 2 refined white earthenware sherds, blue hand painted decoration, burned
- 1 refined white earthenware sherd, blue transfer printed, burned
- 2 refined white earthenware sherds (mend), blue shell edge decoration, rim fragments, burned
- 10 refined white earthenware sherds, undecorated, burned

- 2 refined white earthenware sherds, unidentified blue decoration, rim fragments, burned
- 4 refined white earthenware spalls, undecorated

Glass

- 5 unidentified clear sherds, flat
- 1 unidentified glass sherd, curved, heavily burned
- 3 unidentified light aqua sherds, flat
- 2 unidentified olive green spalls

Metal

- 1 lead shot
- 1 unidentified ferrous metal fragment
- 1 unidentified nail fragment

Miscellaneous

- 2 bone 5-hole sew through buttons - 1.7 cm diameters
- 13 bone fragments, some with blue paint
- 263 brick fragments, 8.8 grams
- 16 leather fragments
- 2 oyster shell fragments, 0.1 grams
- 14 seed/pit fragments

Block 2, Feature 15, East Half, inside barrel, Level 2, Light

Miscellaneous

- 3 seed fragments

Block 2, Feature 15, West Half, inside barrel, Level 2

Ceramics

- 2 buff and grey bodied coarse stoneware sherds (mend), clear salt glazed exterior, brown glazed interior, crock rim fragments
- 2 buff and grey bodied coarse stoneware sherds, clear salt glazed exterior, brown glazed interior
- 1 buff bodied coarse stoneware sherd, unglazed interior, grey salt glazed exterior, base fragment
- 1 grey bodied coarse stoneware sherd, clear salt glazed exterior, unglazed interior
- 1 grey bodied coarse stoneware sherd, kiln waster fragment
- 1 refined white earthenware sherd, green shell edge, rim/base fragment, flat vessel burned/stained
- 1 refined white earthenware sherd, hand painted finial fragment, burned/stained
- 2 refined white earthenware sherds, blue hand painted, burned/stained
- 8 refined white earthenware sherds, blue shell edge, rim fragments, burned/stained
- 3 refined white earthenware sherds, blue shell edge, rim/base fragments, flat vessel, burned/stained
- 3 refined white earthenware sherds, undecorated, base fragments, stained/burned
- 6 refined white earthenware sherds, undecorated, stained/burned

Glass

- 1 aqua multi-sided bottle sherd, base fragment, open pontil, heavily opalized/degraded (pre-1860)
- 1 clear cylindrical tableware sherd, base fragment, pontil (pre-1860)
- 1 olive green cylindrical bottle sherd, bulged kick-up base fragment, refired pontil, contact mold (1810-1860)
- 1 unidentified sherd, burned, curved
- 4 windowpane sherds, soda/potash (pre-1864)

Metal

- 1 copper button, wire eye attachment, stamped on reverse "PATENT/COLOUR" -- 1.8 cm diameter
- 1 cut nail fragment, machine headed (post-1830)
- 1 strap iron fragment
- 1 unidentified brass/copper strip
- 2 unidentified ferrous metal fragments
- 1 unidentified lead ring

Miscellaneous

- 6 bone fragments
- 1 brick fragment, 9.1 grams
- 1 charcoal fragment
- 2 leather shoe fragments
- 5 oyster shell fragments, 83.9 grams
- 2 peach pit fragments
- 1 wood 4-hole sew through button, with depression in center on both sides -- 1.2 cm diameter

Block 2, Feature 15A, Outside Barrel, SW Quad

Ceramics

- 1 buff bodied coarse stoneware sherd, salt glazed exterior, unglazed interior, burned
- 1 grey bodied coarse stoneware sherd, clear glazed interior and exterior, probably base fragment
- 1 refined white earthenware sherd, blue transfer printed, burned/stained
- 3 refined white earthenware sherds, undecorated, burned/stained

Metal

- 1 ferrous metal chain link fragment
- 1 unidentified brass rod fragment
- 1 unidentified cut or wrought nail fragment
- 3 unidentified ferrous metal fragments

Miscellaneous

- 2 brick fragments, 10.7 grams
- 1 slag

Block 2, Feature 15A, West Bisection, outside barrel, Level

Ceramics

- 1 grey bodied coarse stoneware sherd, clear salt glazed exterior, unglazed interior, base fragment
- 1 refined white earthenware sherd, undecorated, burned/stained
- 1 refined white earthenware sherd, unidentified blue decoration, rim fragment, burned/stained

Glass

- 1 clear cylindrical bottle/jar sherd
- 2 light greenish-aqua square/rectangular bottle sherds, embossed "...ERMI..."

Metal

- 1 brass flat disc button, partial wire eye attachment -- 1.8 cm diameter
- 1 copper British George III farthing, bust of George III with "GEORGEIVS III REX", on obverse, person with staff sitting or leaning on shield, "BRITAN NIA 1775" (1775)
- 1 lead shot, 1.7 cm diameter

Miscellaneous

- 1 brick fragment, 1.7 grams
- 1 oyster shell fragment, 14.2 grams
- 1 wood 5-hole sew through button -- 1.6 cm diameter

Block 2, Test Unit 4, Feature 15A, Fill

Ceramics

- 1 hard paste porcelain sherd, undecorated

Block 2, Test Unit 4, Fill 5

Ceramics

- 1 grey bodied coarse stoneware sherd, clear salt glazed exterior, unglazed interior
- 1 grey bodied coarse stoneware sherd, clear salt glazed exterior, unglazed interior, hollow vessel, base fragment
- 2 refined white earthenware sherds, blue transfer printed, burned
- 2 refined white earthenware sherds, undecorated, burned

Glass

- 2 light green oval bottle sherds (mend), Lafayette pictorial flask, embossed "[KENSINGTON GLASS WORKS PHILA] DELPHIA", American Eagle with, "[T.W.] D" in oval frame (1824-1825, McKearin 1948)

Miscellaneous

- 1 bone fragment, burned
- 1 brick fragment, 33.6 grams

Block 2, Test Unit 4, Fill 8

Metal

- 1 unidentified ferrous metal fragment
- 1 unidentified ferrous metal fragment, possible blade or machinery part fragment

Block 2, Test Unit 5, Fill 1, sample

Ceramics

- 1 American Rockingham/Bennington sherd, undecorated rim or base fragment (1800-1912, Miller 1992)
- 2 ironstone sherds, undecorated (1840-1900+, Miller 1992)
- 1 redware sherd, clear glazed interior, unglazed exterior
- 2 refined white earthenware sherds, undecorated, base fragments, burned/stained
- 3 refined white earthenware sherds, undecorated, burned/stained
- 2 refined white earthenware spalls
- 1 whiteware sherd, unidentified blue decoration (1820-1900+, South 1977; Miller 1992)
- 2 whiteware sherds, blue transfer printed rim fragment (1820-1900+, South 1977; Miller 1992)

Glass

- 1 dark olive green cylindrical bottle sherd
- 1 unidentified clear sherd, burned/stained
- 3 unidentified very pale aqua sherds, flat
- 1 very pale aqua cylindrical bottle sherd
- 1 white milk glass 4-hole sew through button -- 1.0 cm diameter
- 1 windowpane sherd, soda/potash (pre-1864)
- 3 windowpane sherds, lime soda (1864-present)

Metal

- 3 cut nail fragments (post-1790)
- 6 cut nail fragments, machine headed, one pulled (post-1830)
- 3 ferrous metal curry comb fragments
- 1 unidentified nail fragment, T-head

Miscellaneous

- 8 bone fragments, four calcined
- 3 brick fragments, one burned, 75.1 grams
- 1 charcoal fragment
- 1 coal fragment
- 3 peach pit fragments
- 3 shell fragments, 7.1 grams

Trench 02, Fill 08

Ceramics

- 1 ironstone sherd, undecorated (1840-1900+, Miller 1992)
- 1 ironstone sherd, undecorated rim fragment (1840-1900+, Miller 1992)
- 1 ironstone sherd, undecorated rim/base fragment (1840-1900+, Miller 1992)
- 1 refined white earthenware sherd, undecorated, burned/stained
- 1 refined white earthenware sherd, unidentified green decoration, rim fragment
- 1 whiteware sherd, flow blue decoration, base fragment (1820-1900+, South 1977; 1835-1870+, Miller 1992)
- 1 whiteware sherd, undecorated (1820-1900+, South 1977; Miller 1992)

Glass

- 1 amber rectangular/oval bottle sherd, worn
- 1 clear entire rectangular small bottle, prescription lip, probably medicinal bottle (1820s-1870)
- 1 clear rectangular/oval bottle sherd, embossed "...WEST MEASURE.../...PINT" on front, applied ring with collar lip
- 1 light aqua square/rectangular bottle sherd, stained

Metal

- 1 unidentified nail fragment

Trench 02, Fill 10

Ceramics

- 1 pearlware sherd, blue shell edge, rim/base fragment, flat vessel (1780-1830, South 1977; Miller 1992)
- 2 pearlware sherds, undecorated (1780-1830, South 1977; Miller 1992)
- 1 refined white earthenware sherd, blue transfer printed, burned/stained, possibly pearlware
- 1 whiteware sherd, flow blue decoration (1820-1900+, South 1977; 1835-1870+, Miller 1992)
- 1 whiteware sherd, undecorated, base fragment, probably tea cup (1820-1900+, South 1977; Miller 1992)

Trench 04, Approx. 4.5' BGS, in South Wall profile at 30'

Glass

- 2 green and white milk glass flash glass cylindrical bottle sherds

Trench 04, B/C Horizon, 6.3' - 6.5' BGS

Ceramics

- 1 grey bodied coarse stoneware sherd, clear salt glazed exterior, clear glazed interior, rim fragment
- 2 grey bodied coarse stoneware sherds, clear salt glazed exterior, clear glazed interior
- 1 grey bodied coarse stoneware, kiln waster furniture
- 2 hard paste porcelain sherds, blue hand painted
- 1 redware sherd, brown glazed interior, unglazed exterior
- 1 refined white earthenware sherd, undecorated, burned/stained

Glass

- 1 olive amber cylindrical bottle sherd
- 1 olive green cylindrical bottle sherd, stained

Metal

- 1 ferrous metal stirrup fragment

Miscellaneous

- 1 slate fragment
- 2 teeth fragments, burned

Trench 06, 1' Below Feature 13

Ceramics

- 1 grey bodied coarse stoneware sherd, base fragment, burned

Miscellaneous

- 5 bone fragments, burned
- 1 wood fragment, burned

Trench 06, around Feature 15, Fill 8

Ceramics

- 3 grey and buff bodied coarse stoneware sherds, clear salt glazed exterior, light brown glazed interior
- 1 grey bodied coarse stoneware sherd, reddish glazed exterior, light brown glazed interior, rim and lug handle fragment, slightly burned
- 1 refined white earthenware sherd, blue shell edge, scalloped rim fragment, burned
- 1 refined white earthenware sherd, green shell edge, scalloped rim fragment, burned
- 1 refined white earthenware sherd, undecorated base fragment, burned
- 2 refined white earthenware sherds, undecorated, burned

Metal

- 1 cut nail fragment, burned (post-1790)
- 1 unidentified ferrous metal fragment, thin
- 1 unidentified nail fragment

Miscellaneous

- 4 bone fragments, burned, at least one sawed
- 1 brick fragment, heavily burned, 143.1 grams
- 1 oyster shell fragment, burned, 20.8 grams

Trench 06, around Features 13 and 14, Fill 8

Ceramics

- 1 refined redware sherd, undecorated (1800-1840, Magid 1990)
- 1 refined white earthenware sherd, base fragment, heavily burned
- 1 refined white earthenware sherd, blue rim band, rim fragment, burned/stained, probably whiteware
- 1 refined white earthenware sherd, undecorated, stained, probably pearlware or whiteware
- 1 whiteware sherd, blue transfer printed, embossed rim, rim fragment (1820-1900+, South 1977; 1830-1865+, Miller 1992)
- 1 whiteware sherd, green transfer printed, rim fragment (1820-1900+, South 1977; 1825-1875+, Miller 1992)

Glass

- 1 dark olive green cylindrical bottle sherd, worn, contact mold (1810-1880)
- 1 green cylindrical bottle sherd
- 1 greenish-aqua cylindrical bottle sherd, base fragment
- 1 olive green cylindrical bottle sherd, worn

Metal

- 1 cut nail fragment, unidentified head, burned (post-1790)
- 2 unidentified ferrous metal fragments
- 1 wire fragment, burned

Miscellaneous

- 3 black leather fragments, probably from shoe, burned
- 1 brick fragment, 40 grams
- 3 leather shoe heel fragments, wire nail/tacks, possibly ladies size, burned
- 1 tooth fragment, burned

Prehistoric

- 1 quartz flake, partial
- 1 quartzite flake, partial

Trench 06, East End, Fill 6

Ceramics

- 1 ironstone sherd, undecorated (1840-1900+, Miller 1992)
- 1 kaolin pipe bowl fragment
- 1 refined white earthenware sherd, undecorated
- 1 whiteware sherd, blue transfer printed, rim fragment (1820-1900+, South 1977; 1830-1865+, Miller 1992)
- 2 whiteware sherds, undecorated (1820-1900+, South 1977; Miller 1992)
- 2 whiteware sherds, undecorated rim fragments, one stained (1820-1900+, South 1977; Miller 1992)

Trench 06, East End, Fill 8

Ceramics

- 1 buff bodied coarse stoneware sherd, clear salt glazed exterior, clear glazed interior, slightly burned
- 5 hard paste porcelain sherds (mend), gilded and blue overglaze enamel, base fragment, hollow vessel
- 5 hard paste porcelain sherds, undecorated
- 1 ironstone sherd, undecorated rim fragment, hollow vessel (1840-1900+, Miller 1992)
- 5 ironstone sherds, undecorated (1840-1900+, Miller 1992)
- 2 ironstone sherds, undecorated base fragments (1840-1900+, Miller 1992)

Glass

- 1 clear cylindrical bottle/jar sherd, embossed/molded ridges, base fragment
- 1 dark aqua cylindrical bottle sherd
- 1 white milk glass cylindrical bottle sherd

Metal

- 1 unidentified cast iron rod, bent

Miscellaneous

- 1 clear plastic fragment
- 1 coal fragment
- 3 oyster shell fragments, burned, 60.6 grams

Trench 06, Feature 13, Fill within box (screened)

Ceramics

- 1 grey and buff bodied coarse stoneware sherd, cobalt decorated and clear salt glazed exterior, clear glazed interior, slightly burned
- 2 kaolin pipe stem fragments, one with embossed decoration
- 2 refined white earthenware sherds, undecorated, burned

Glass

- 1 olive green cylindrical bottle sherd, base fragment, worn

Miscellaneous

- 2 bone fragments, burned
- 1 oyster shell fragment, 12.8 grams

Trench 07, Feature 4, Level 1

Ceramics

- 1 pearlware sherd, undecorated (1780-1830, South 1977; Miller 1992)
- 1 redware sherd, unglazed base fragment, burned
- 1 whiteware sherd, blue shell edge rim fragment (1820-1900+, South 1977; 1830-1860+, Miller 1992)
- 1 whiteware sherd, undecorated (1820-1900+, South 1977; Miller 1992)

Glass

- 1 clear cylindrical bottle sherd, neck fragment
- 2 clear cylindrical bottle/jar sherds
- 1 honey amber cylindrical bottle sherd
- 1 unidentified clear sherd, curved, thin
- 3 unidentified very pale green sherds, worn

Metal

- 3 unidentified ferrous metal fragments
- 8 unidentified ferrous metal fragments, probably nails

Miscellaneous

- 1 brick fragment, 0.6 grams
- 4 coal fragments
- 11 oyster shell fragments, 86.7 grams
- 1 walnut shell or peach pit fragment

Trench 07, Feature 4, Level 2

Ceramics

- 1 ironstone sherd, undecorated base fragment, slightly burned (1840-1900+, Miller 1992)

Trench 07, Test Unit 1, Fill above cobbles

Ceramics

- 2 buff bodied coarse stoneware sherds, light brown glazed exterior, unglazed interior, base fragments, probably bottle
- 1 ironstone sherd, undecorated rim fragment, hollow vessel (1840-1900+, Miller 1992)
- 2 ironstone sherds, undecorated (1840-1900+, Miller 1992)
- 1 kaolin pipe stem fragment, stamped "DAVIDSON; GLASGOW", slightly worn (mid-18th-19th century, Hume 1976)

1 refined white earthenware sherd, undecorated, stained, probably
pearlware

- 1 whiteware sherd, flow blue decoration (1820-1900+, South 1977; 1835-1870+, Miller 1992)
- 2 whiteware sherds, blue shell edge, rim fragments (1820-1900+, South 1977; 1830-1860+, Miller 1992)

Glass

- 1 cobalt cylindrical bottle sherd, stained
- 1 light aqua cylindrical bottle sherd, base fragment, stained, possibly freeblown
- 2 light olive green cylindrical bottle sherds, one stained, one possibly freeblown
- 3 olive green cylindrical bottle sherds, contact mold (1810-1880)
- 1 unidentified clear sherd, flat

Metal

- 1 unidentified ferrous metal fragment, possible nail

Miscellaneous

- 1 bone fragment
- 2 oyster shell fragments, burned, 35.6 grams

Trench 07, Test Unit 1, Level 1

Ceramics

- 1 ironstone sherd, undecorated (1840-1900+, Miller 1992)
- 3 ironstone sherds, undecorated, base fragments (1840-1900+, Miller 1992)
- 1 pearlware sherd, undecorated (1780-1830, South 1977; Miller 1992)
- 1 redware sherd, brown glazed interior, unglazed exterior
- 2 refined white earthenware sherds, undecorated, burned/stained
- 1 whiteware sherd, pink spatter/sponge decoration, rim fragment (1820-1900+, South 1977; 1830-1865+, Miller 1992)
- 1 whiteware sherd, unidentified blue decoration (1820-1900+, South 1977; Miller 1992)
- 4 whiteware sherds, blue transfer printed (1820-1900+, South 1977; 1830-1865+, Miller 1992)
- 2 whiteware sherds, undecorated rim fragments (1820-1900+, South 1977; Miller 1992)
- 2 whiteware sherds, undecorated, one with molded ridges (1820-1900+, South 1977; Miller 1992)

Glass

- 1 honey amber square/rectangular/oval bottle sherd
- 2 light aqua cylindrical bottle sherds, one with unidentified embossing
- 3 olive green cylindrical bottle sherds
- 1 unidentified light greenish-aqua sherd, flat, probably potash-soda windowpane, stained
- 2 unidentified pale aqua sherds, opalized
- 1 white milk glass 4-hole sew through button -- 1.3 cm diameter
- 1 white milk glass cylindrical bottle/jar sherd, base fragment

Metal

- 6 unidentified ferrous metal fragments
- 7 unidentified nail fragments

Miscellaneous

- 5 bone fragments
- 1 cinder fragment
- 1 coal fragment
- 2 shell fragments, 44.7 grams

Trench 07, Test Unit 1, Level 2

Ceramics

- 1 grey bodied coarse stoneware sherd, clear salt glazed exterior, light brown glazed/slipped interior, large crock base fragment
- 1 grey bodied coarse stoneware sherd, cobalt decorated and salt glazed exterior, clear glazed interior
- 1 hard paste porcelain sherd, toy doll arm
- 1 hard paste porcelain sherd, undecorated
- 1 ironstone sherd, undecorated (1840-1900+, Miller 1992)
- 2 kaolin pipe stem fragments
- 1 soft paste porcelain sherd, molded or embossed decoration, stained
- 1 whiteware sherd, blue spatter/sponge decoration, rim fragment (1820-1900+, South 1977; 1830-1865+, Miller 1992)
- 1 whiteware sherd, dark pink spatter/sponge decoration (1820-1900+, South 1977; 1830-1865+, Miller 1992)
- 1 whiteware sherd, undecorated (1820-1900+, South 1977; Miller 1992)
- 2 whiteware sherds, blue/purple transfer printed, probably flow blue (1820-1900+, South 1977; 1825-1875+, Miller 1992)
- 2 whiteware sherds, undecorated base fragments (1820-1900+, South 1977; Miller 1992)
- 1 yellowware sherd, undecorated, base fragment (1830-1940, Miller 1992)

Glass

- 2 clear cylindrical bottle/jar sherds, one with embossed/molded ridges
- 4 dark olive green cylindrical bottle sherds, possibly freeblown or contact mold (pre-1880)
- 1 light olive green cylindrical bottle sherd
- 1 olive green cylindrical bottle sherd, stained

Metal

- 2 cut nail fragments (post-1790)
- 8 unidentified ferrous metal fragments

Miscellaneous

- 1 bone fragment, calcined
- 1 brick fragment
- 1 coal fragment
- 1 shell fragment, burned, 4.0 grams

Prehistoric

- 1 quartz flake, partial

Trench 07, Test Unit 1, North Half, Level 2

Ceramics

- 1 American Rockingham/Bennington sherd, undecorated rim fragment (1800-1912, Miller 1992)
- 1 buff bodied coarse stoneware sherd, clear glazed exterior, unglazed interior, base fragment
- 6 buff bodied coarse stoneware sherds (mend), light brown glazed exterior, unglazed interior, small crock or jug base fragments
- 1 grey bodied coarse stoneware sherd, clear salt glazed exterior, clear glazed interior
- 1 grey bodied coarse stoneware sherd, cobalt hand painted and clear salt glazed exterior, brown glazed interior, slightly burned
- 1 hard paste porcelain sherd, undecorated rim fragment, hollow vessel
- 1 hard paste porcelain sherd, undecorated rim/base plate fragment
- 6 ironstone sherds, undecorated (1840-1900+, Miller 1992)
- 2 ironstone sherds, undecorated base fragments (1840-1900+, Miller 1992)
- 1 pearlware sherd, polychrome hand painted (1795-1815, South 1977; 1780-1835, Miller 1992)
- 1 redware sherd, light brown glazed interior, unglazed exterior
- 1 redware sherd, unglazed interior and exterior, rim fragment
- 3 redware sherds, unglazed interior and exterior
- 1 refined white earthenware sherd, undecorated base fragment, stained
- 1 refined white earthenware sherd, undecorated, burned/stained
- 1 whiteware sherd, blue shell edge, rim fragment (1820-1900+, South 1977; 1830-1860+, Miller 1992)
- 1 whiteware sherd, pink spatter/sponge decoration (1820-1900+, South 1977; 1830-1865+, Miller 1992)
- 1 whiteware sherd, unidentified blue decoration, rim fragment (1820-1900+, South 1977; Miller 1992)
- 4 whiteware sherds, blue transfer printed (1820-1900+, South 1977; 1830-1865+, Miller 1992)
- 4 whiteware sherds, undecorated (1820-1900+, South 1977; Miller 1992)
- 4 whiteware sherds, unidentified blue decoration (1820-1900+, South 1977; Miller 1992)

Glass

- 5 clear cylindrical bottle/jar sherds, one lip fragment, one embossed/molded
- 1 dark greenish-aqua cylindrical bottle sherd, worn, opalized
- 1 green blackglass cylindrical bottle sherd, contact mold (1810-1880)
- 1 greenish-aqua cylindrical bottle sherd, unidentified embossing, worn
- 1 light aqua square/rectangular bottle sherd, stained
- 1 light greenish-aqua cylindrical bottle sherd, stained
- 1 light olive green cylindrical bottle sherd
- 1 olive amber blackglass cylindrical bottle sherd, contact mold (1810-1880)

- 17 olive green cylindrical bottle sherds, some stained, one embossed
"...TEN..." on shoulder
- 4 pale aqua cylindrical bottle sherds, stained
- 1 unidentified aqua sherd, flat, opalized
- 5 unidentified clear sherds, curved, thin
- 3 unidentified very pale aqua sherds, stained
- 4 unidentified windowpane sherds, stained

Metal

- 1 ferrous metal possible buckle fragment
- 9 unidentified ferrous metal fragments
- 16 unidentified ferrous metal fragments, probably nails
- 2 unidentified ferrous metal strips, curved, approx. 1.5" wide

Miscellaneous

- 10 bone fragments, two calcined
- 11 brick fragments, 47.7 grams
- 2 coal fragments
- 8 shell fragments, burned, 161.9 grams

Trench 07, Test Unit 1, South Half, Level 2

Ceramics

- 1 hard paste porcelain sherd, undecorated base fragment
- 1 pearlware sherd, polychrome hand painted, base fragment, stained
(1795-1815, South 1977; 1780-1835, Miller 1992)
- 1 pearlware sherd, undecorated, rim/base fragment, flat vessel, stained
(1780-1830, South 1977; Miller 1992)
- 4 pearlware sherds (3 mend), blue transfer printed, base fragments (1795-
1840, South 1977; 1787-1830, Miller 1992)
- 2 pearlware sherds, blue transfer printed (1795-1840, South 1977; 1787-
1830, Miller 1992)
- 2 pearlware sherds, blue transfer printed, rim fragments (1795-1840,
South 1977; 1787-1830, Miller 1992)
- 4 pearlware sherds, undecorated (1780-1830, South 1977; Miller 1992)
- 1 refined white earthenware sherd, undecorated, burned/stained
- 1 whiteware sherd, blue transfer printed (1820-1900+, South 1977; 1830-
1865+, Miller 1992)
- 1 whiteware sherd, flow blue decoration, rim fragment (1820-1900+,
South 1977; 1835-1870+, Miller 1992)
- 1 whiteware sherd, undecorated (1820-1900+, South 1977; Miller 1992)
- 2 whiteware sherds, flow blue decoration (1820-1900+, South 1977;
1835-1870+, Miller 1992)

Glass

- 2 olive green cylindrical bottle sherds
- 1 pale aqua cylindrical bottle sherd, stained
- 1 unidentified aqua spall
- 1 unidentified clear sherd
- 1 unidentified green spall
- 2 unidentified pale aqua sherds, flat, stained

- 1 windowpane sherd, soda (pre-1864)

Metal

- 4 unidentified ferrous metal fragments, probably nails
- 2 unidentified nail fragments

Miscellaneous

- 2 bone fragments
- 3 coal fragments
- 1 mortar fragment, 6.9 grams
- 6 oyster shell fragments, burned, 49.8 grams

Trench 07, West End, Fill 8

Ceramics

- 1 kaolin pipe stem fragment, embossed with stars and horizontal bars, and "...ER; D..."
- 1 whiteware sherd, polychrome hand painted, rim fragment (1820-1900+, South 1977; 1825-1860+, Miller 1992)

Glass

- 9 dark olive green cylindrical bottle sherds (mend), embossed on base "WHITNEY ... WORKS", contact mold (1840-1880, Encyclopedia of Antiques 2007)

Trench 09, Artifact Sample, Fill 3 and 4

Ceramics

- 1 grey bodied coarse stoneware sherd, brown salt glazed exterior, unglazed interior
- 2 grey bodied stoneware sherds, brown glazed exterior, unglazed interior, possibly refined
- 1 ironstone sherd, undecorated, handle fragment (1840-1900+, Miller 1992)
- 3 ironstone sherds, undecorated (1840-1900+, Miller 1992)
- 1 light grey bodied refined stoneware sherd, clear glazed interior and exterior, base fragment, possibly Rhenish stoneware
- 1 pearlware sherd, green shell edge (1780-1830, South 1977; 1800-1830, Miller 1992)
- 1 pearlware sherd, polychrome cat's eye and probably annular decoration (1790-1820, South 1977; Miller 1992)
- 1 redware sherd, dark brown glazed interior and exterior
- 1 whiteware sherd, blue spatter/sponge decoration (1820-1900+, South 1977; 1830-1865+, Miller 1992)
- 1 whiteware sherd, undecorated base fragment (1820-1900+, South 1977; Miller 1992)
- 1 whiteware sherd, undecorated rim fragment (1820-1900+, South 1977; Miller 1992)
- 1 whiteware sherd, unidentified blue rim decoration, rim fragment, probably shell edge (1820-1900+, South 1977; Miller 1992)
- 2 whiteware sherds, blue transfer printed (1820-1900+, South 1977; 1830-1865+, Miller 1992)
- 3 whiteware sherds, undecorated (1820-1900+, South 1977; Miller 1992)

Glass

- 1 green cylindrical bottle sherd, worn
- 1 greenish-aqua cylindrical bottle sherd, worn
- 1 olive green blackglass cylindrical bottle sherd, lip fragment (pre-1880)
- 1 pale green cylindrical bottle sherd
- 1 white milk glass 4-hole sew through button fragment -- 1.4 cm diameter

Metal

- 2 brass fragments (mend), thin, rolled, stamped "PAT SER 2...4/
AMERICAN GRAPHITE/ ... JERSEY CITY NJ"
- 1 unidentified ferrous metal fragment
- 1 unidentified nail fragment

Miscellaneous

- 2 bone fragments

Trench 09, Artifact Sample, Fill 4

Ceramics

- 1 whiteware sherd, gilded rim band and unidentified blue rim decoration, rim/base fragment, hollow vessel (1820-1900+, South 1977; Miller 1992)

Trench 09, Artifact Sample, Fill 5

Ceramics

- 1 grey and buff bodied coarse stoneware sherd, cobalt and clear salt glazed, handle fragment
- 1 pearlware sherd, undecorated (1780-1830, South 1977; Miller 1992)
- 1 pearlware sherd, undecorated rim fragment (1780-1830, South 1977; Miller 1992)

Metal

- 1 unidentified ferrous metal fragment

Trench 09, Feature 07, West Half

Metal

- 1 wire or wire nail fragment

Trench 09, Feature 08, South Half

Ceramics

- 1 grey bodied coarse stoneware sherd, clear salt glazed exterior, clear glazed interior
- 1 pearlware sherd, applied clay chips
- 1 whiteware sherd, undecorated (1820-1900+, South 1977; Miller 1992)
- 1 whiteware sherd, unidentified blue glazed/decoration (1820-1900+, South 1977; Miller 1992)

Glass

- 1 light aqua cylindrical/oval bottle sherd, base fragment, opalized
- 1 unidentified clear sherd
- 1 unidentified possible citron/light olive green sherd, slightly curved
- 1 unidentified very pale aqua sherd
- 3 windowpane sherds, soda/lime soda

Metal

- 2 cut nail fragments, machine headed (post-1830)
- 5 unidentified nail fragments

Miscellaneous

- 1 oyster shell, burned, 56.7 grams

Trench 09, Feature 09, Northwest Half

Ceramics

- 1 refined white earthenware sherd, undecorated, burned

Glass

- 1 greenish-aqua cylindrical bottle sherd

Trench 09, Feature 11

Ceramics

- 1 light grey bodied coarse stoneware sherd, unidentified cobalt decorated exterior, light brown/clear glazed interior and exterior, rim fragment
- 1 whiteware sherd, undecorated (1820-1900+, South 1977; Miller 1992)

Glass

- 1 unidentified pale aqua sherd, worn/stained

Trench 10, At 14 feet, Fill 6

Ceramics

- 1 hard paste porcelain sherd, polychrome decal decoration, rim fragment, hollow vessel (post-1890)
- 1 ironstone sherd, undecorated, base fragment (1840-1900+, Miller 1992)
- 1 opaque porcelain sherd, undecorated, rim/base fragment, flat vessel (post-1880, Magid 1990)

Glass

- 1 amber cylindrical bottle sherd
- 1 clear entire rectangular bottle, embossed with triangle on base, possible early automatic bottle machine with tooled single banded collar lip (1890-1930)
- 1 dark green cylindrical bottle sherd, embossed "...ER", base fragment
- 1 pale aqua cylindrical bottle sherd, base fragment, embossed "1" on base
- 1 pale aqua cylindrical/oval bottle sherd, embossed "...DAVIS..." on shoulder, possible tooled lip

Metal

- 1 unidentified lead fragment, probably handle or drawer pull

Trench 10, At 44 feet, Fill 6

Ceramics

- 1 ironstone sherd, undecorated, black maker's mark on base, two people with shield and eagle, banner with unidentified writing below, "IRONSTONE CHIN...", base fragment, stained, Maryland Queensware Company (post-1879, Kovel 1953)

Metal

- 1 U.S. brass small one cent, Indian head, shield on reverse (1866)

Trench 10, Feature 24, Fill on Top of Feature

Ceramics

- 1 kaolin pipe stem fragment
- 1 pearlware sherd, undecorated (1780-1830, South 1977; Miller 1992)

Trench 10, Feature 24, Inside Barrel, Level 1

Ceramics

- 1 whiteware sherd, undecorated rim fragment (1820-1900+, South 1977; Miller 1992)
- 1 whiteware sherd, unidentified blue decoration (1820-1900+, South 1977; Miller 1992)

Glass

- 1 clear cylindrical bottle sherd, crown cap lip fragment, automatic bottle machine (1910-present)
- 2 clear cylindrical bottle/jar sherds
- 2 clear cylindrical tableware sherds, rim fragments, one pressed (post-1827)
- 1 unidentified clear sherd

Metal

- 2 unidentified ferrous metal fragments, one possible nail

Miscellaneous

- 12 brick fragments, 45.1 grams
- 5 coal fragments
- 2 unidentified shell fragments, 0.3 grams

Trench 10, Feature 24, Inside Barrel, Level 2

Ceramics

- 1 refined white earthenware sherd, unidentified green glazed/decoration

Miscellaneous

- 5 brick fragments, 19.7 grams
- 9 coal fragments
- 1 oyster shell fragment, 0.7 grams
- 1 unidentified seed/pit fragment, burned

Trench 10, Feature 24, Inside Barrel, Level 3

Miscellaneous

- 2 unidentified black material, charcoal or slag fragments
- 1 wood fragment, flat, rounded edges, split, probably barrel lid fragment

Trench 10, Feature 24, Inside Barrel, Level 4

Metal

- 1 unidentified brass fragment, thin, bent

Miscellaneous

- 3 seed/pits
- 10 slag fragments

Trench 10, Feature 24, Inside Barrel, Soil Sample of Barrel

Glass

- 1 unidentified clear glass spall

Miscellaneous

- 2 mortar fragments, 0.1 grams
- 4 nut fragments
- 8 slag, 1.5 grams

Trench 10, Feature 24a, NE Quad, Outside Barrel, Level 1

Ceramics

- 1 grey bodied stoneware sherd, brown glazed exterior, unglazed interior, possibly refined
- 3 ironstone sherds, undecorated (1840-1900+, Miller 1992)
- 1 kaolin pipe bowl fragment, molded decoration
- 1 pearlware sherd, polychrome hand painted, base fragment, flat vessel (1795-1815, South 1977; 1780-1835, Miller 1992)
- 1 refined white earthenware sherd, undecorated, stained/burned, handle fragment
- 1 refined white earthenware spall
- 1 whiteware sherd, undecorated rim fragment (1820-1900+, South 1977; Miller 1992)

Glass

- 1 clear cylindrical bottle/jar sherd, embossed/molded, opalized
- 1 clear cylindrical bottle/jar sherd, opalized
- 1 pale aqua cylindrical bottle sherd
- 1 unidentified amber sherd, opalized
- 6 unidentified clear sherds, curved
- 2 unidentified green spalls
- 3 unidentified light aqua sherds, stained
- 1 windowpane sherd, lime soda (1864-present)

Metal

- 5 cut nail fragments, machine headed (post-1830)
- 9 unidentified ferrous metal fragments
- 3 unidentified nail fragments

Miscellaneous

- 3 bone fragments
- 20 brick fragments, 46.8 grams
- 12 coal fragments
- 12 shell fragments, burned, 9.4 grams
- 1 walnut husk fragment

Trench 10, Feature 24a, NE Quad, Outside Barrel, Level 2

Ceramics

- 1 opaque porcelain sherd, blue transfer printed (post-1880, Magid 1990)
- 1 refined white earthenware sherd, polychrome hand painted, burned/stained
- 1 refined white earthenware sherd, undecorated, possibly pearlware, burned/stained
- 1 whiteware sherd, blue transfer printed, rim fragment (1820-1900+, South 1977; 1830-1865+, Miller 1992)
- 3 whiteware sherds, undecorated (1820-1900+, South 1977; Miller 1992)
- 1 yellowware sherd, undecorated (1830-1940, Miller 1992)

Glass

- 1 amber cylindrical bottle sherd, opalized
- 1 clear cylindrical tableware/goblet sherd, stem and base of glass fragment, glass portion pressed (post-1827)
- 3 pale aqua cylindrical bottle sherds
- 3 unidentified clear sherds, slightly curved, opalized

Metal

- 1 cut 10d nail, machine headed (post-1830)
- 1 cut 5d nail, machine headed (post-1830)
- 1 cut 8d nail, machine headed, pulled (post-1830)
- 6 cut nail fragments, machine headed (post-1830)
- 3 unidentified ferrous metal fragments

Miscellaneous

- 4 bone fragments
- 3 brick fragments, 29.2 grams
- 4 coal fragments
- 10 oyster shell fragments, some burned, 78.2 grams

Trench 10, Feature 24a, NE Quad, Outside Barrel, Level 3

Ceramics

- 1 grey and buff bodied coarse stoneware sherd, brown slipped interior and exterior
- 1 whiteware sherd, polychrome annular decoration, rim fragment (1820-1900+, South 1977; 1830-1875+, Miller 1992)
- 1 whiteware sherd, unidentified polychrome decoration (1820-1900+, South 1977; Miller 1992)
- 2 whiteware sherds, undecorated (1820-1900+, South 1977; Miller 1992)
- 2 whiteware sherds, undecorated rim fragments (1820-1900+, South 1977; Miller 1992)

Glass

- 1 windowpane sherd, lime soda (1864-present)

Metal

- 1 cut 6d nail, machine headed, burned (post-1830)
- 1 cut nail fragment, machine headed, burned (post-1830)
- 1 unidentified ferrous metal fragment, probably nail

Miscellaneous

- 1 coal fragment
- 1 tooth fragment

Trench 10, Feature 24a, NW Quad, Outside Barrel, Level 1

Ceramics

- 1 coarse stoneware sherd, rim fragment, heavily burned
- 1 hard paste porcelain sherd, undecorated
- 1 refined buff bodied earthenware sherd, possible unidentified brown decoration, thin, probably handle fragment
- 1 refined white earthenware sherd, unidentified blue decoration, rim fragment
- 1 refined white earthenware sherd, unidentified orange decoration
- 1 whiteware sherd, blue annular decoration (1820-1900+, South 1977; 1830-1875+, Miller 1992)
- 1 whiteware sherd, polychrome annular decoration (1820-1900+, South 1977; 1830-1875+, Miller 1992)
- 1 whiteware sherd, undecorated rim fragment (1820-1900+, South 1977; Miller 1992)
- 9 whiteware sherds, undecorated (1820-1900+, South 1977; Miller 1992)

Glass

- 6 clear cylindrical bottle/jar sherds, stained, one embossed/molded
- 1 olive green cylindrical bottle sherd, contact mold (1810-1880)
- 1 olive green cylindrical bottle sherd, stained
- 1 pale aqua cylindrical bottle sherd, lightning ground lip fragment, opalized (1872-1910)
- 5 pale aqua cylindrical bottle sherds, opalized
- 1 unidentified clear sherd, flat, stained
- 1 unidentified olive amber spall
- 5 unidentified very pale aqua sherds, flat, opalized

Metal

- 5 cut nail fragments, burned (post-1790)
- 4 cut nail fragments, machine headed, one pulled, burned (post-1830)
- 4 unidentified ferrous metal fragments
- 1 unidentified nail fragment

Miscellaneous

- 1 bone fragment
- 5 brick fragments, 83.7 grams
- 4 coal fragments
- 9 oyster shell fragments, 71.6 grams

Trench 10, Feature 24a, NW Quad, Outside Barrel, Level 2,

Ceramics

- 1 whiteware sherd, undecorated rim fragment (1820-1900+, South 1977; Miller 1992)
- 7 whiteware sherds, undecorated (1820-1900+, South 1977; Miller 1992)

Glass

- 1 amber cylindrical bottle sherd, opalized
- 1 olive green cylindrical bottle sherd
- 1 pale aqua cylindrical bottle sherd
- 1 windowpane sherd, soda (pre-1864)
- 3 windowpane sherds, lime soda, stained (1864-present)

Metal

- 1 cut nail fragment, machine headed (post-1830)
- 3 unidentified ferrous metal fragments

Miscellaneous

- 2 bone fragments
- 1 coal fragment

Trench 10, Feature 24a, Outside Barrel, Level 3

Ceramics

- 1 refined white earthenware sherd, whiteware or ironstone, undecorated, stained

Glass

- 1 unidentified very pale aqua sherd, curved, opalized

Metal

- 1 unidentified ferrous metal fragment
- 1 wire fragment

Miscellaneous

- 1 coal fragment
- 4 shell fragments, burned, 9.9 grams

Trench 10, Feature 24a, Outside Barrel, Level 4

Ceramics

- 1 ironstone spall, undecorated (1840-1900+, Miller 1992)

Glass

- 2 unidentified clear sherds, thin, one curved, stained
- 1 unidentified very pale green sherd

Metal

- 1 cut 8d nail, machine headed (post-1830)
- 1 cut nail fragment, machine headed (post-1830)
- 2 cut nail fragments (post-1790)
- 9 unidentified ferrous metal fragments
- 1 wire nail fragment (1890-present)

Miscellaneous

- 2 bone fragments
- 4 brick fragments, 95.2 grams
- 4 coal fragments

- 1 peach pit

Trench 10, Feature 25

Ceramics

- 1 hard paste porcelain sherd, undecorated
- 1 hard paste porcelain sherd, undecorated base fragment
- 1 ironstone sherd, undecorated, black maker's mark on base, "WARRANTED IRONSTONE CHINA" lion and unicorn with banner, unidentified writing on banner, base fragment, stained, flat vessel, Etruria Pottery, Trenton, NJ (1863-1894, Kovel 1986)
- 1 redware sherd, brown glazed interior, unglazed exterior
- 1 whiteware sherd, blue transfer printed, handle fragment, probably pitcher (1820-1900+, South 1977; 1830-1965+, Miller 1992)

Trench 10, Feature 25, Fill

Ceramics

- 1 grey bodied coarse stoneware sherd, brown glazed exterior, unglazed interior
- 1 refined white earthenware sherd, undecorated, bowl rim fragment, burned/stained

Glass

- 5 honey amber oval bottle sherds (mend), applied double collared lip, embossed "F" on base, opalized

Metal

- 1 ferrous metal bed spring fragment

Miscellaneous

- 2 large bone fragments, burned/stained

Trench 10, Feature 26, 6' BGS, Fill

Miscellaneous

- 1 bone, whole, burned

Trench 10, Feature 26, East Half, Level 1

Ceramics

- 3 whiteware sherds, undecorated (1820-1900+, South 1977; Miller 1992)

Glass

- 2 unidentified clear sherds, flat, one opalized
- 1 unidentified very pale aqua sherd, flat, opalized

Metal

- 1 unidentified ferrous metal fragment, probably nail

Miscellaneous

- 11 brick fragments, 20.1 grams
- 1 clam shell fragment, 2.0 grams
- 7 coal fragments
- 3 oyster shell fragments, 36.5 grams
- 1 slag fragment

Trench 10, Feature 26, East Half, Level 2

Glass

- 1 pale aqua cylindrical bottle sherd, embossed "...RS", opalized
- 1 unidentified clear spall

Metal

- 2 cut nail fragments, machine headed, burned

Miscellaneous

- 2 brick spalls, 2.2 grams
- 1 coal fragment
- 1 concrete/mortar fragment, 127.8 grams

Trench 10, Feature 26, East Half, under Feature 26

Ceramics

- 1 kaolin pipe stem fragment

Glass

- 1 unidentified pale aqua sherd, flat

Metal

- 1 cut nail fragment, burned (post-1790)

Miscellaneous

- 2 bone fragments
- 1 brick fragment, 0.8 grams
- 1 oyster shell fragment, 11.2 grams

Trench 10, Feature 26, West Half

Ceramics

- 2 ironstone spalls, undecorated (1840-1900+, Miller 1992)

Glass

- 2 unidentified olive green sherds
- 1 unidentified pale aqua sherd, flat, stained
- 1 windowpane sherd, lime soda (1864-present)

Metal

- 3 unidentified nail fragments, one pulled, burned

Miscellaneous

- 2 bone fragments
- 12 brick fragments, 42.4 grams
- 6 coal fragments
- 1 shell fragment, 1.4 grams

Trench 10, Feature 26, West Half, Heavy Fraction

Ceramics

- 1 hard paste porcelain sherd, undecorated
- 2 refined white earthenware sherds, undecorated

Glass

- 1 clear tableware sherd, rim fragment
- 4 unidentified clear spalls
- 1 unidentified light green sherd, flat
- 2 unidentified olive green spalls, flat

Metal

- 5 unidentified ferrous metal fragments

Miscellaneous

- 6 bone fragments
- 94 brick fragments, 49.1 grams
- 13 seed fragments
- 26 shell fragments, two burned, 2.9 grams

Trench 10, Feature 26, West Half, Light Fraction

Miscellaneous

- 21 seed/pit fragments

Trench 10, Feature 27, West Half

Glass

- 2 clear cylindrical bottle/jar sherds
- 1 light aqua square/rectangular bottle sherd, opalized
- 2 windowpane sherds, lime soda (1864-present)

Metal

- 1 cut nail fragment (post-1790)

Miscellaneous

- 7 brick fragments, 50.7 grams
- 4 coal fragments
- 1 oyster shell fragment, 1.8 grams
- 1 peach pit fragment

Trench 10, Feature 30, Fill

Metal

- 1 wire nail fragment, pulled (1890-present)

Miscellaneous

- 1 wood handle fragment

Trench 10, Feature 32 Bisection

Ceramics

- 1 grey bodied coarse stoneware spall, clear salt glazed

Glass

- 9 clear cylindrical bottle/jar sherds

Miscellaneous

- 1 brick fragment, 2.6 grams
- 3 oyster shell fragments, 9.5 grams

Trench 10, Feature 32, Fill Directly above Fill

Ceramics

- 1 hard paste porcelain sherd, toy cup fragment

Glass

- 2 clear cylindrical bottle/jar sherds, stained

Metal

- 1 brass knob, drawer pull

Trench 10, Test Unit 2, Fill 1, Level 1

Ceramics

- 1 refined white earthenware sherd, undecorated or unidentified very pale yellow/brown glazed, rim or base fragment, slightly stained
- 1 whiteware sherd, unidentified blue decoration (1820-1900+, South 1977; Miller 1992)

Glass

- 3 amber cylindrical bottle sherds
- 7 clear cylindrical bottle/jar sherds, one embossed/molded
- 1 clear cylindrical entire bottle, embossed on base "P. J. RITTER CONSERVE CO. / A", cork fragment also recovered, improved tooled finish lip, possible catsup bottle (1890s-1910s, SHA 2007)
- 2 clear manganese cylindrical bottle sherds (1880-1915)
- 2 light aqua cylindrical bottle sherds (mend), lip fragment, opalized
- 5 unidentified clear sherds
- 2 unidentified clear sherds, curved, thin, rim fragments, probably lamp chimney fragments

Metal

- 1 brass rectangular strip, thin, bent, two nails at one end
- 2 cut 4d nails, machine headed (post-1830)
- 8 ferrous metal wire fragments
- 20 unidentified ferrous metal fragments
- 1 unidentified nail fragment, probably cut, burned
- 1 wire 8d nail, pulled (1890-present)

Miscellaneous

- 4 brick fragments, 17.5 grams
- 2 coal fragments
- 2 leather fragments
- 1 mortar fragment, 19.9 grams
- 3 oyster shell fragments, 35.9 grams
- 4 slag
- 2 wood fragments, one cut, rounded on one end, one flat with small holes in center

Trench 10, Test Unit 2, Fill 1, Level 2

Ceramics

- 1 ironstone sherd, undecorated (1840-1900+, Miller 1992)
- 1 refined white earthenware sherd, unidentified blue decoration, probably flow blue
- 1 stoneware tile fragment, white glazed
- 1 unidentified ceramic sherd, probably grey bodied stoneware, undecorated
- 2 whiteware sherds, undecorated (1820-1900+, South 1977; Miller 1992)

Glass

- 1 amber cylindrical bottle sherd
- 1 clear cylindrical bottle/jar sherd, base fragment
- 3 clear cylindrical bottle/jar sherds, one embossed/molded, one opalized
- 1 clear cylindrical entire bottle, early screw threaded lip with collar, cork fragment inside bottle, opalized
- 1 clear cylindrical jar sherd, lip fragment
- 1 light olive green cylindrical bottle sherd, stained
- 2 olive green cylindrical bottle sherds
- 4 pale aqua cylindrical bottle sherds, one base fragment, opalized
- 3 unidentified clear sherds
- 1 unidentified olive green spall
- 13 unidentified very pale aqua sherds, flat, opalized
- 1 unidentified white milk glass sherd, flat
- 2 windowpane sherds, lime soda (1864-present)
- 6 windowpane sherds, soda/lime soda

Metal

- 1 cut 20d nail, machine headed (post-1830)
- 1 cut 9d nail, machine headed (post-1830)
- 4 cut nail fragments, machine headed, burned (post-1830)
- 3 ferrous metal wire fragments
- 6 unidentified ferrous metal fragments
- 1 wire 8d nail, pulled (1890-present)

Miscellaneous

- 4 bone fragments
- 1 cork fragment
- 13 oyster shell fragments, 107.6 grams
- 1 rubber fragment, burned

Trench 10, Test Unit 2, Fill 1, Level 3

Ceramics

- 1 American Rockingham/Bennington sherd, molded (1800-1912, Miller 1992)
- 1 refined white earthenware sherd, violet/mulberry transfer printed, rim fragment, burned/stained

Glass

- 1 amber cylindrical bottle sherd, worn/opalized
- 2 olive green cylindrical bottle sherds
- 1 unidentified clear sherd, slightly curved
- 11 windowpane sherds, unidentified, stained

Metal

- 1 cut 7d nail, machine headed, pulled, burned (post-1830)
- 1 ferrous metal safety pin fragment
- 1 ferrous metal wire fragment, bent

Miscellaneous

- 6 oyster shell fragments, 58.1 grams

Trench 10, Test Unit 2, Fill 2, Level 1

Glass

- 1 olive green cylindrical bottle sherd, neck fragment
- 1 unidentified clear sherd, flat, stained
- 1 unidentified olive green sherd, flat
- 1 unidentified very pale aqua sherd, flat, opalized

Miscellaneous

- 4 brick fragments, 3.9 grams
- 12 oyster shell fragments, 167.1 grams

Trench 10, Test Unit 2, Fill 2, Level 2

Ceramics

- 1 kiln waster furniture fragment
- 1 refined white earthenware sherd, unidentified blue decoration

Glass

- 2 olive green cylindrical bottle sherds
- 2 unidentified pale aqua sherds, slightly curved

Miscellaneous

- 3 leather shoe fragments
- 2 oyster shell fragments, 7.9 grams

Trench 10, Transit Point 1006, Fill 10

Glass

- 6 green cylindrical bottle sherds (mend), base and kick-up fragment, contact mold (1810-1880)

Trench 10, Transit Point 1007, Fill 10

Miscellaneous

- 1 leather shoe, in three pieces

Well Feature, General Collection

Miscellaneous

- 1 shaped round wood fragment, flattened on one side with brass tacks and leather attached

Well Feature 10.8'-9.8' ASL, Yellow Sand Fill

Ceramics

- 1 pearlware sherd, undecorated (1780-1830, South 1977; Miller 1992)
- 1 refined white earthenware sherd, undecorated, burned, stained
- 1 whiteware sherd, undecorated (1820-1900+, South 1977; Miller 1992)

Glass

- 2 unidentified pale aqua sherds, flat, opalized

Metal

- 1 unidentified nail fragment

Well Feature 9.8'-9.3' ASL, Bisection

Ceramics

- 1 hard paste porcelain 4-hole sew through button, grey hand painted decoration - 1.1 cm diameter
- 1 hard paste porcelain sherd, decal decoration (1890-present, Miller 1992)
- 1 hard paste porcelain sherd, over glaze hand painted, toy tea kettle fragment
- 1 hard paste porcelain sherd, red over glaze hand painted, base fragment
- 1 refined white earthenware sherd, undecorated
- 1 whiteware sherd, blue spatter/sponge decoration (1820-1900+, South 1977; 1830-1865+, Miller 1992)
- 1 whiteware sherd, green rim band, rim fragment (1820-1900+, South 1977; 1830-1975+, Miller 1992)
- 1 whiteware sherd, undecorated (1820-1900+, South 1977; Miller 1992)
- 1 whiteware sherd, undecorated, rim fragment (1820-1900+, South 1977; Miller 1992)
- 1 yellowware sherd, undecorated (1830-1940, Miller 1992)

Glass

- 1 light aqua cylindrical bottle/jar sherd, stained
- 1 light aqua cylindrical bottle/jar sherd, unidentified letter embossing as well as "...C...", stained
- 1 mirror fragment
- 1 unidentified clear sherd, stained
- 2 unidentified clear sherds, thin, curved
- 8 unidentified light aqua sherds, flat, stained
- 1 white milk glass 4-hole sew through button - 1.6 cm diameter

Metal

- 1 thin aluminum fragment
- 1 unidentified ferrous metal fragment, flat, curved
- 8 unidentified ferrous metal fragments
- 4 unidentified nail fragments
- 1 wire nail fragment (1890-present)

Miscellaneous

- 1 brick fragment, 1.9 grams
- 1 coal fragment
- 1 concrete fragment
- 1 conglomerate of metal and glass fused together
- 1 mortar fragment, 41.6 grams
- 14 mortar with plaster fragments, 61.9 grams
- 1 oyster shell fragment, 4.2 grams
- 1 thin plastic fragment (discarded)

Well Feature 9.3'-8.8' ASL, Bisection

Ceramics

- 1 whiteware sherd, blue transfer printed, (1820-1900+, South 1977; 1830-1865+, Miller 1992)

Glass

- 1 aqua cylindrical jar sherd, continuous screw threaded, very stained (post-1924)
- 1 light aqua cylindrical bottle/jar sherd, very stained
- 1 unidentified aqua sherd, flat
- 1 unidentified clear sherd, stained
- 1 unidentified greenish aqua sherd, flat

Metal

- 1 cast iron pipe fragment
- 3 cut nail fragments (post-1790)
- 2 unidentified ferrous metal fragments
- 4 unidentified nail fragments

Miscellaneous

- 1 bone fragment
- 2 bone fragments, one calcined
- 3 brick fragments, 62 grams
- 4 coal fragments
- 1 leather fragment with small tacking nails, probably part of a shoe
- 1 light green plastic fragment, dimple pattern
- 2 mortar fragments, 5.1 grams
- 4 mortar with plaster fragments, 24.3 grams
- 1 oyster shell fragment, 0.1 grams
- 1 slate fragment

Prehistoric

- 1 quartz primary reduction flake, whole, utilized distal margin, cortex proximal

Well Feature 8.8'-8.3' ASL, Bisection

Ceramics

- 1 pearlware sherd, undecorated (1780-1830, South 1977; Miller 1992)
- 1 porcelain hollow tube fragment, unglazed
- 1 redware sherd, unglazed exterior, brown glaze interior

Glass

- 1 aqua cylindrical bottle/jar sherd, very stained
- 1 clear cylindrical bottle/jar sherd, automatic bottle machine (ABM) (1910-present)
- 1 clear cylindrical tableware sherd, pressed, geometric design, scalloped rim fragment (1827-present)
- 1 unidentified clear sherd, thin, curved
- 12 unidentified light aqua sherds, flat, opalized
- 1 windowpane sherd, lime soda (1864-present)

Metal

- 4 cut nail fragments (post-1790)
- 2 unidentified ferrous metal fragments
- 7 unidentified nail fragments
- 2 wire nail fragments (1890-present)

Miscellaneous

- 3 bone fragments
- 1 charcoal fragment
- 1 coal fragment
- 4 mortar fragments, 7.0 grams
- 7 mortar with plaster fragments, 22.1 grams
- 4 oyster shell fragments, 16.4 grams

Well Feature 8.5'-8.0' ASL, South Half

Ceramics

- 1 American Rockingham/Bennington sherd, base fragment, slightly burned (1800-1912, Miller 1992; 1845-1900+, Magid 1990)
- 1 buff bodied coarse stoneware sherd, Albany slipped interior and exterior (post-1805)
- 1 grey bodied coarse stoneware sherd, unglazed interior and exterior, base fragment
- 1 hard paste porcelain sherd, molded rim decoration, rim fragment
- 1 hard paste porcelain sherd, undecorated, base fragment
- 3 ironstone sherds, undecorated (1840-1900+, Miller 1992)
- 3 kaolin pipe bowl fragments
- 1 kaolin pipe stem fragment, embossed "GLAS..." and "...DSON"
- 4 pearlware sherds, undecorated (1780-1830, South 1977; Miller 1992)
- 1 whiteware sherd, blue annular decoration (1820-1900+, South 1977; 1830-1875+, Miller 1992)
- 1 whiteware sherd, molded rim decoration, rim fragment, stained/burned (1820-1900+, South 1977; 1845-1885+, Miller 1992)
- 1 whiteware sherd, undecorated (1820-1900+, South 1977; Miller 1992)
- 1 whiteware sherd, unidentified blue decoration (1820-1900+, South 1977; Miller 1992)
- 2 whiteware sherds, undecorated, base fragments, stained/burned (1820-1900+, South 1977; Miller 1992)
- 3 whiteware sherds, undecorated, stained/burned (1820-1900+, South 1977; Miller 1992)
- 1 yellowware sherd, polychrome annular decoration (1830-1940, Miller 1992)
- 1 yellowware sherd, undecorated (1830-1940, Miller 1992)
- 1 yellowware sherd, undecorated, base fragment (1830-1940, Miller 1992)

Glass

- 6 aqua cylindrical bottle/jar sherds, stained/worn
- 1 clear cylindrical bottle/jar sherd, molded decoration, automatic bottle machine (ABM) (1910-present)
- 1 clear cylindrical bottle/jar sherd, unidentified embossing, scratched/stained
- 2 clear cylindrical bottle/jar sherds, one ribbed, scratched/stained
- 7 clear cylindrical bottle/jar sherds, scratched/stained
- 1 clear cylindrical lamp chimney, machine crimped (post-1866)
- 1 clear cylindrical tableware sherd, pressed scalloped edge (1827-present)
- 1 clear multi sided bottle/jar sherd, scratched/opalized
- 1 light aqua cylindrical bottle/jar sherd, unidentified embossing, very heavily opalized
- 1 light green cylindrical bottle sherd, embossed "...REGIS...", automatic bottle machine (ABM) (1907-present)
- 1 light green cylindrical bottle sherd, opalized
- 2 olive green cylindrical bottle sherds (mend), contact mold, base fragments (1810-1880)
- 2 olive green cylindrical bottle sherds, scratched/worn
- 3 orange amber cylindrical bottle sherds, very stained/opalized
- 3 unidentified aqua sherds, flat, scratched/stained
- 5 unidentified clear sherds, curved, thin, stained
- 1 unidentified green sherd, flat, opalized
- 54 unidentified light aqua sherds, scratched/stained
- 4 unidentified windowpane sherds, scratched/stained
- 1 white milk glass 4-hole sew through button - 1.4 cm diameter
- 1 white milk glass button fragment
- 4 windowpane sherds, lime soda (1864-present)
- 3 windowpane sherds, potash, stained (pre-1864)
- 2 windowpane sherds, potash/soda, scratched/stained (pre-1864)

Metal

- 1 brass .22 caliber cartridge casing
- 1 brass washer fragment
- 1 ferrous metal 5-hole sew through button - 1.6 cm diameter
- 46 unidentified ferrous metal fragments
- 5 wire nail fragments (1890-present)

Miscellaneous

- 16 bone fragments
- 1 brick fragment, 1.5 grams
- 3 cinder fragments
- 2 coal fragments
- 8 mortar fragments with plaster, 19.6 grams
- 2 mortar, 18.0 grams
- 10 oyster shell fragments, 133.8 grams
- 1 slag, 2.3 grams

Well Feature 8.3'-7.8' ASL, Bisection

Ceramics

- 1 whiteware sherd, undecorated (1820-1900+, South 1977; Miller 1992)
- 1 whiteware sherd, unidentified blue decoration (1820-1900+, South 1977; Miller 1992)
- 2 whiteware sherds, undecorated, rim fragments (1820-1900+, South 1977; Miller 1992)

Glass

- 1 light aqua cylindrical bottle/jar sherd, scratched/stained
- 1 unidentified clear sherd, scratched/stained
- 7 unidentified windowpane sherds, scratched/stained

Metal

- 1 unidentified ferrous metal fragment
- 7 unidentified nail fragments

Miscellaneous

- 2 bone fragments
- 2 mortar fragments with plaster, 5.0 grams
- 1 oyster shell fragment, 3.9 grams
- 1 plastic fragment, black, half-circle shaped, two holes in center

Well Feature 8.0'-7.5' ASL, South Half

Ceramics

- 2 American Rockingham/Bennington sherds, one molded handle fragment (1800-1912, Miller 1992; 1845-1900+, Magid 1990)
- 1 hard paste porcelain figurine fragment, bird claw over a blue painted ball
- 1 hard paste porcelain marble, polychrome overglaze annular decoration-1.4 cm diameter
- 1 hard paste porcelain sherd, figurine face fragment, nose portion of the face
- 1 hard paste porcelain sherd, gild decal decoration, scalloped rim fragment
- 1 hard paste porcelain sherd, paneled rim fragment, probably toy tea cup
- 1 kaolin pipe stem fragment
- 1 pearlware sherd, undecorated (1780-1830, South 1977; Miller 1992)
- 1 refined white earthenware sherd, stained
- 1 refined white earthenware spall
- 1 soft paste porcelain shirt stud, incised decoration -1.1 cm diameter
- 1 whiteware sherd, gild decal decoration, (1890-present, Miller 1992)
- 1 whiteware sherd, molded rim decoration, scalloped rim fragment (1820-1900+, South 1977; 1845-1885+, Miller 1992)
- 1 whiteware sherd, undecorated, base fragment (1820-1900+, South 1977; Miller 1992)
- 3 whiteware sherds, undecorated (1820-1900+, South 1977; Miller 1992)
- 2 whiteware sherds, undecorated, rim fragments (1820-1900+, South 1977; Miller 1992)
- 2 whiteware sherds, unidentified blue decoration (1820-1900+, South 1977; Miller 1992)

- 1 yellowware sherd, undecorated (1830-1940, Miller 1992)

Glass

- 1 amber cylindrical bottle sherd, unidentified letter embossing, stained
- 1 aqua cylindrical bottle/jar sherd, embossed "2009" on base, whole base, automatic bottle machine (ABM), (1907-present)
- 1 clear cylindrical bottle/jar sherd, automatic bottle machine (ABM) (1910-present)
- 1 clear cylindrical bottle/jar sherd, ribbed, automatic bottle machine, slightly opalized (ABM) (1910-present)
- 3 clear cylindrical bottle/jar sherds, opalized
- 3 clear cylindrical tableware sherds (mend), pressed decoration (post-1827)
- 1 clear multi-sided bottle/jar sherd, stained
- 2 clear tableware sherds, scalloped rim fragments, slightly frosted
- 1 light aqua cylindrical bottle/jar sherd, letter embossing "...URT...", very stained
- 5 light aqua cylindrical bottle/jar sherds, stained
- 1 light aqua cylindrical jar sherd, threaded rim fragment, very stained
- 1 light green cylindrical bottle sherd, stained
- 1 unidentified clear sherd, stained
- 4 unidentified clear sherds, thin, curved
- 42 unidentified light aqua sherds, flat, stained
- 1 unidentified light aqua sherd, heat melted
- 1 unidentified light blue fragment
- 2 white milk glass 4-hole sew through buttons - 1.0 cm diameter
- 1 white milk glass 4-hole sew through buttons - 1.1 cm diameter
- 31 windowpane sherds, lime soda, stained (1864-present)

Metal

- 10 cut nail fragments
- 1 ferrous metal threaded screw
- 19 unidentified ferrous metal fragments
- 3 unidentified ferrous metal fragments, flat
- 14 unidentified nail fragments
- 5 wire nail fragments
- 1 zinc or tin button cap, wire fastener- 1.4 cm diameter

Miscellaneous

- 7 bone fragments
- 1 cinder fragment
- 1 mortar fragment, 55.5 grams
- 3 mortar fragments with plaster, 11.4 grams
- 2 shell fragments, 47.4 grams

Well Feature 7.8'-7.3' ASL, Bisection

Ceramics

- 1 hard paste porcelain sherd, unidentified blue decoration, rim fragment
- 1 kaolin pipe bowl and stem fragment, molded decoration, reverse arch with lines radiating from center
- 1 pearlware sherd, polychrome finger-painted decoration (1790-1820, South 1977; Miller 1992)
- 1 pearlware sherd, unidentified blue decoration
- 1 refined white earthenware sherd, unidentified green decoration, rim fragment
- 1 whiteware sherd, blue annular decoration (1820-1900+, South 1977; 1830-1875+, Miller 1992)
- 1 whiteware sherd, undecorated (1820-1900+, South 1977; Miller 1992)
- 1 whiteware sherd, unidentified polychrome decoration (1820-1900+, South 1977; Miller 1992)

Glass

- 3 aqua cylindrical bottle/jar sherds, scratched/stained
- 2 clear cylindrical bottle/jar sherds, scratched/stained
- 1 clear cylindrical tableware sherd, pressed (1827-present)
- 1 clear cylindrical tableware sherd, scratched/stained
- 2 unidentified clear sherds, thin, curved, scratched/stained
- 11 unidentified light aqua sherds, flat, scratched/stained
- 6 windowpane sherds, lime soda, scratched/stained (1864-present)

Metal

- 1 cut nail fragments (post-1790)
- 4 unidentified ferrous metal fragments
- 1 unidentified nail fragments
- 3 wire nail fragments (1890-present)

Miscellaneous

- 6 bone fragments
- 1 brick fragment, 2.8 grams
- 9 coal fragments
- 10 mortar fragments with plaster, 38.4 grams
- 3 mortar fragments, 10.2 grams
- 6 oyster shell fragments, 134.4 grams
- 1 rounded/worn stone

Well Feature 7.5'-7.0' ASL, South Half

Ceramics

- 1 clay marble
- 1 creamware sherd, undecorated (1762-1820, South 1977; Miller 1992)
- 1 creamware sherd, undecorated, rim fragment (1762-1820, South 1977; Miller 1992)
- 1 hard paste porcelain marble, annular overglaze decoration
- 1 hard paste porcelain sherd, red decal decoration (1890-present, Miller 1992)
- 2 hard paste porcelain sherds, undecorated, one burned

- 1 refined white earthenware sherd, brown glaze
- 1 refined white earthenware sherd, undecorated, burned
- 2 refined white earthenware sherd, unidentified blue decoration
- 1 whiteware sherd, polychrome decal floral decoration, molded rim decoration, scalloped rim fragment, (1890-present, Miller 1992)
- 1 whiteware sherd, undecorated, handle fragment (1820-1900+, South 1977; Miller 1992)
- 1 whiteware sherd, violet transfer printed, base fragment (1820-1900+, South 1977; 1825-1875+, Miller 1992)
- 2 whiteware sherds, undecorated (1820-1900+, South 1977; Miller 1992)
- 2 whiteware sherds, undecorated, rim fragments, burned (1820-1900+, South 1977; Miller 1992)

Glass

- 6 aqua cylindrical bottle/jar sherds, one base fragment, very stained
- 2 bright olive green cylindrical bottle sherds, automatic bottle machine (ABM) (1907-present)
- 2 clear cylindrical bottle sherds, neck fragments, stained
- 1 clear cylindrical bottle sherd, prescription lip fragment, scratched (mid 1870's-early 1920's)
- 1 clear cylindrical bottle/jar sherd, very scratched
- 5 clear cylindrical bottle/jar sherds, stained and opalized
- 1 clear cylindrical lamp chimney fragment, machine crimped (post-1866)
- 1 clear cylindrical tableware sherd, pressed geometric pattern, goblet fragment where meets the stem
- 1 clear manganese cylindrical bottle/jar sherd, rim fragment, opalized (1880-1915)
- 1 honey amber cylindrical bottle sherd, stained and scratched
- 1 light aqua bottle/jar sherd, stained
- 2 unidentified clear sherds
- 73 unidentified light aqua sherds, flat
- 2 unidentified light aqua sherds, stained
- 4 unidentified light aqua, thin, flat
- 1 white milk glass 4-hole sew through button -1.0 cm diameter
- 43 windowpane sherds, lime soda (1864-present)

Metal

- 1 cut 9d nail, machine headed (post-1830)
- 17 cut nail fragments (post-1790)
- 2 cut spike fragments
- 1 ferrous metal washer
- 19 unidentified ferrous metal fragments
- 12 unidentified ferrous metal fragments, flat
- 1 unidentified nail fragments
- 18 wire nail fragments (1890-present)

Miscellaneous

- 6 bone fragments
- 1 cinder fragment
- 1 coal fragment
- 2 oyster shell fragments, 177.7 grams
- 1 slate fragment, flat
- 1 slate pencil

Well Feature 7.1' ASL, Builder's Trench

Ceramics

- 1 grey and buff bodied coarse stoneware sherd, grey salt glazed exterior, unglazed interior

Miscellaneous

- 1 brick fragment, 56.9 grams

Well Feature 7.0'-6.4' ASL, South Half

Ceramics

- 1 American Rockingham/Bennington sherd (1800-1912, Miller 1992; 1845-1900+, Magid 1990)
- 1 brown bodied coarse stoneware sherd, unglazed interior, salt glazed exterior
- 1 grey and buff bodied coarse stoneware sherd, unglazed interior, salt glazed exterior
- 2 refined white earthenware sherds, undecorated, burned

Glass

- 1 ball blue glass chunk
- 2 light aqua cylindrical bottle/jar sherds
- 1 orange amber cylindrical bottle sherd, opalized
- 1 unidentified clear sherd, thin, curved, opalized
- 4 unidentified light aqua sherds, flat
- 6 windowpane sherds, lime soda, scratched/stained (1864-present)

Metal

- 3 cut nail fragments (post-1790)
- 1 spike fragment
- 1 unidentified ferrous metal fragment, flat, square
- 9 unidentified ferrous metal fragments
- 4 unidentified nail fragments
- 1 wire fragment

Miscellaneous

- 3 bone fragments
- 1 kiln waster fragment
- 1 slate fragment

Well Feature 6.8'-6.5' ASL, NE Quarter

Ceramics

- 1 redware sherd, unglazed
- 1 refined white earthenware sherd, undecorated
- 1 whiteware sherd, polychrome spatter/sponge decoration (1820-1900+, South 1977; 1830-1865+, Miller 1992)
- 1 whiteware sherd, undecorated (1820-1900+, South 1977; Miller 1992)
- 1 whiteware sherd, unidentified blue decoration (1820-1900+, South 1977; Miller 1992)
- 1 whiteware sherd, unidentified blue decoration, rim fragment (1820-1900+, South 1977; Miller 1992)
- 1 whiteware sherd, unidentified green decoration (1820-1900+, South 1977; Miller 1992)

Glass

- 1 light green bottle/jar sherd, heavily stained
- 1 light green bottle/jar sherd, stained
- 1 light green spall
- 8 unidentified light green sherds, flat, stained
- 4 windowpane sherds, lime soda (1864-present)

Metal

- 6 cut nail fragments (post-1790)
- 1 unidentified ferrous metal fragment
- 1 unidentified ferrous metal, flat
- 2 unidentified nail fragments
- 2 wire nail fragments (1890-present)

Miscellaneous

- 1 bone fragment, calcined
- 1 brick fragment, 22.7 grams
- 2 coal fragments
- 1 mortar fragment, 0.5 grams
- 1 oyster shell fragment, 11.8 grams

Well Feature 6.8'-6.3' ASL, NW Quarter

Ceramics

- 1 American Rockingham/Bennington sherd, undecorated (1800-1912, Miller 1992; 1845-1900+, Magid 1990)
- 1 buff and grey bodied coarse stoneware sherd, brown glaze interior, unglazed interior
- 1 hard paste porcelain sherd, undecorated, rim fragment
- 2 whiteware sherds, undecorated (1820-1900+, South 1977; Miller 1992)
- 1 yellowware sherd, undecorated (1830-1940, Miller 1992)

Glass

- 1 aqua cylindrical bottle/jar sherd, stained
- 1 Ball blue cylindrical canning jar sherd, automatic bottle machine (ABM) (1909-1938)
- 1 clear cylindrical bottle/jar sherd, embossing "...MADE...", automatic bottle machine (ABM) (1910-present)
- 1 clear cylindrical bottle/jar sherd, unidentified ribbing, opalized
- 1 clear cylindrical tableware sherd, rim fragment, stained and scratched
- 1 clear oval bottle/jar sherd, automatic bottle machine (ABM) (1910-present)
- 4 light aqua cylindrical bottle/jar sherds, stained
- 1 light aqua jar sherd, threading fragments, stained
- 1 mirror fragment
- 1 olive green cylindrical bottle sherd, contact mold (1810-1880)
- 1 unidentified clear sherd, thin, curved
- 17 unidentified light aqua sherds, flat, stained
- 3 unidentified light green sherds, flat
- 2 windowpane sherds, lime soda (1864-present)

Metal

- 4 cut nail fragments (post-1790)
- 1 ferrous metal crown cap (post-1890)
- 11 unidentified ferrous metal fragments
- 4 unidentified nail fragments
- 3 wire nail fragments (1890-present)

Miscellaneous

- 3 bone fragments
- 1 brick fragment with blue plaster, 4.4 grams
- 3 brick fragments, 87.5 grams
- 1 cinder fragment
- 3 coal fragments
- 3 mortar fragments, 31.6 grams
- 8 mortar with plaster fragments, 20.4 grams
- 2 oyster shell fragments, 42.4 grams
- 1 particle board with paint

Well Feature 6.8'-5.8' ASL, Builder's Trench at base of

Metal

- 1 cut nail fragment (post-1790)

Miscellaneous

- 2 brick fragments, 14.7 grams
- 1 white plastic fragment, ribbed

Well Feature 6.5' ASL, NE Quarter

Glass

- 1 unidentified light aqua sherd, flat

Metal

- 1 cut nail fragment (post-1790)
- 2 unidentified nail fragments

Miscellaneous

- 1 kiln waster fragment
- 2 nut/pit fragments

Well Feature 6.4' ASL, South Half

Glass

- 1 light aqua cylindrical bottle/jar sherd, very heavily opalized

Metal

- 2 unidentified ferrous metal fragments

Miscellaneous

- 6 brick fragments, 169.1 grams
- 1 walnut shell fragment, 0.2 grams

Well Feature, Removal of thin wood layer at base of level

Miscellaneous

- 2 brick fragments, 5.5 grams
- 1 oyster shell fragment, 1.4 grams

Well Feature, South Profile

Glass

- 1 aqua cylindrical bottle/jar sherd, unidentified letter embossing, stained

APPENDIX IV
Cultural Resource Forms

DHR ID#: 44AX0202

City/County: Alexandria
VDHR Site Number: 44AX0202
Site Name:
Temporary Designation: 44AXKING

Other VDHR Number:

CULTURAL/TEMPORAL AFFILIATION

Cultural Designation
Euro-American

Temporal Designation
19th Century

Site Class: Terrestrial, open air

THEMATIC CONTEXTS/SITE FUNCTIONS

Sequence Number: 1

Category for thematic context:
Domestic

Example: Dwelling, multiple
Comments/Remarks:

2007)This site is associated with the occupation of this city block by various households dating from as early as the late 18th century, but more likely the early to mid 19th century to the beginning of the 20th century. The 20th century and modern components lacked context and are not included in the site.

Specialized Contexts:

USGS Quadrangle(s): ALEXANDRIA

Loran:

Restrict UTM Data?

Center UTM (for less than 10 acres): 18/4297250/321397

Boundary UTMs (for 10 acres or more):

Physiographic Province: Coastal Plain
Drainage: Potomac/Shenandoah River
Landform: urban
Aspect: Flat
Elevation: 16.00 Slope: 0-2%
Site Soils: Modern and Historic Fills
Adjacent Soils: Fills
Nearest Water Source: Hooff Run (Historic)
Distance: 100

INDIVIDUAL/ORGANIZATION/AGENCY INFORMATION

Individual Category Codes:

Honorif:
First:
Last:
Suffix:
Title:
Company/Agency:

Address:

City:
Phone/Ext:

State:

Zip:

Notes:

Ownership type: Private

Gov't Agency:

SITE CHARACTERISTICS

Site Dimensions: 120 feet by 140 feet

Acreage: 0.61

Survey Strategy: Historic Map Projection
Subsurface Testing

Site Condition: 25-49% of Site Destroyed

Survey Description:

Thunderbird Archeology, a division of Wetland Studies and Solutions, Inc. conducted Phase I-III archeological excavations at a 0.61-acre parcel located between 1514 and 1602 King Street and at 1602 Dechantel Street, Alexandria, Virginia.

In the initial phase of this investigation, eight trenches of varying length were mechanically excavated across the site, revealing deep historic fill deposits overlying subsoil. A total of 22 features were identified in six trenches that ranged in date from the 19th through the late 20th century, based on artifacts recovered from the associated historic fills. Additional testing around two of the 19th Century features was conducted. Two larger excavation blocks were mechanically stripped, exposing the features: a cobblestone walkway and/or drainage feature and a barrel cistern with associated wooden box culvert water system.

The site includes artifacts and features associated with the possible late 18th and 19th century occupations of this lot.

Datum for survey coordinates: NAD 1983

CURRENT LAND USE

CURRENT LAND USE # 1

Land Use: Commerce/Trade
Example: Office building

Dates of Use: 2006/05/99

Comments/Remarks:

Site is currently a vacant parking lot for adjacent businesses.

SPECIMENS, FIELDNOTES, DEPOSITORIES

Specimens Obtained? Yes **Specimens Depository:** (2007)Thunderbird Archeology (WSSI), Gainesville, Virginia

Assemblage Description:

(2007)All artifacts in the upper fills appear to be redeposited and are not included in these site only artifact totals.

Domestic artifacts dating from the 18th-20th century representative of several domestic dwellings and occupations during the history of the city block. Ceramic artifacts recovered from the project include ceramics ranging from pipe bowl and stem fragments, hard and soft paste porcelain including some (doll parts and toy tea cup fragments), pearlware (1780-1830), whiteware (1820-1900+), ironstone (1840-1900+), yellowware (1830-1940), redware, Rockingham/Bennington (1800-1910), and stoneware. White ware was the overall dominant dateable ceramic recovered including (173) 27%, followed by ironstone (89) 14%, and pearlware (43) 7% of the ceramic assemblage.

Glass vessels range from bottle and bottle/jar including (champagne-wine, flask, and perfume), tablewares included (tumbler and goblet). Glass technology dates range from contact mold (1810-1880), clear manganese (1880-1915), and automatic bottle machine (1907/1910-present). The highest numbers of dateable glass were contact mold (38) 7%, clear manganese (2) 0.3%, and automatic bottle glass (13) 2% of the glass assemblage. Windowpane includes soda crown (1852), potash, potash/soda, soda, and lime soda). Of the windowpane sherds (1864-present) included (40) 45%, and pre-1864 included (23) 26%.

The majority of the dateable nails included cut (post-1790), and cut machine headed (post-1830), with a few wire nails (post 1890). The dateable nails were dominated by cut machine headed including (43) 41%, cut (25) 24%, and wire (5) 5% of the total nail assemblage while (25) were unidentified.

Other metal objects included brass knob, buttons, cast iron, curry comb, lead, lead shot, coins (copper British George III farthing 1775) (U.S. brass small one cent, Indian head 1866), horseshoe, scabbard throat and finial, and stirrup.

Other artifacts included, bone, brick, cinder, coal, slag, shell, leather and leather shoe fragments, slate, and wooden (button, handle, cork). Prehistoric artifacts included quartz and quartzite partial flakes.

Artifact counts by category include 628 ceramics, 624 glass, 376 metal, 549 miscellaneous, and three prehistoric. Total artifacts recovered from the site 2,180.

Specimens Reported? No

Assemblage description--reported:

Field Notes Reported? Yes **Depository:** (2007) Thunderbird Archeology (WSSI), Gainesville, Virginia

CULTURAL RESOURCE MANAGEMENT EVENTS

Date: 2006/05/99

Cultural Resource Management Event: Archaeological Data Recovery

Organization or Person

First

John

Last

Mullen

Id # Associated with Event:

CRM Event Notes or Comments:

Thunderbird Archeology (WSSI)

PHOTOGRAPHIC DOCUMENTATION AND DEPOSITORY

Sequence Number: 1

Photographic Documentation?

Depository: Thunderbird Archeology (WSSI), Gainesville, VA

Type of Photos: Digital

REPORTS, DEPOSITORY AND REFERENCES

Sequence #: 1

Report (s) ? Yes

Depository: Thunderbird Archeology (WSSI), Gainesville, Virginia

Reference for reports and publications:

Draft: Archeological Investigations of a 0.61-acre Parcel located at 1514-1524, 1600-1602 King Street and 1602 Dechantel Street, Alexandria, Virginia. John P. Mullen, Johnna Flahive, and Boyd Sipe. June 2007.

VDHR Library Reference Number: